



M-5220-MB 2011-2012 Mustang GT Side Exhaust Kit INSTALLATION INSTRUCTIONS

NO PART OF THIS DOCUMENT MAY BE REPRODUCED WITHOUT PRIOR AGREEMENT AND WRITTEN PERMISSION OF FORD RACING PERFORMANCE PARTS.

Please visit www.fordracingparts.com for the most current instruction information.

!!! PLEASE READ ALL OF THE FOLLOWING INSTRUCTIONS CAREFULLY PRIOR TO INSTALLATION. AT ANY TIME YOU DO NOT UNDERSTAND THE INSTRUCTIONS, PLEASE CALL THE FORD RACING TECHLINE AT 1-800-367-3788 !!!

REMOVAL:

- STEP 1:** Loosen the LH and RH catalytic converter-to-exhaust H-pipe ball clamps (#7)
- STEP 2:** Loosen the Torca® couplers (#10)
- STEP 2a:** Slide the Torca® couplers (#10) on to the intermediate pipe (#12) and disconnect the intermediate pipe from the exhaust H-pipe (#9)
- STEP 3:** Remove the exhaust H-pipe.
- STEP 4:** Remove LH and RH plastic shields in front of fuel tank from the underside of the vehicle.

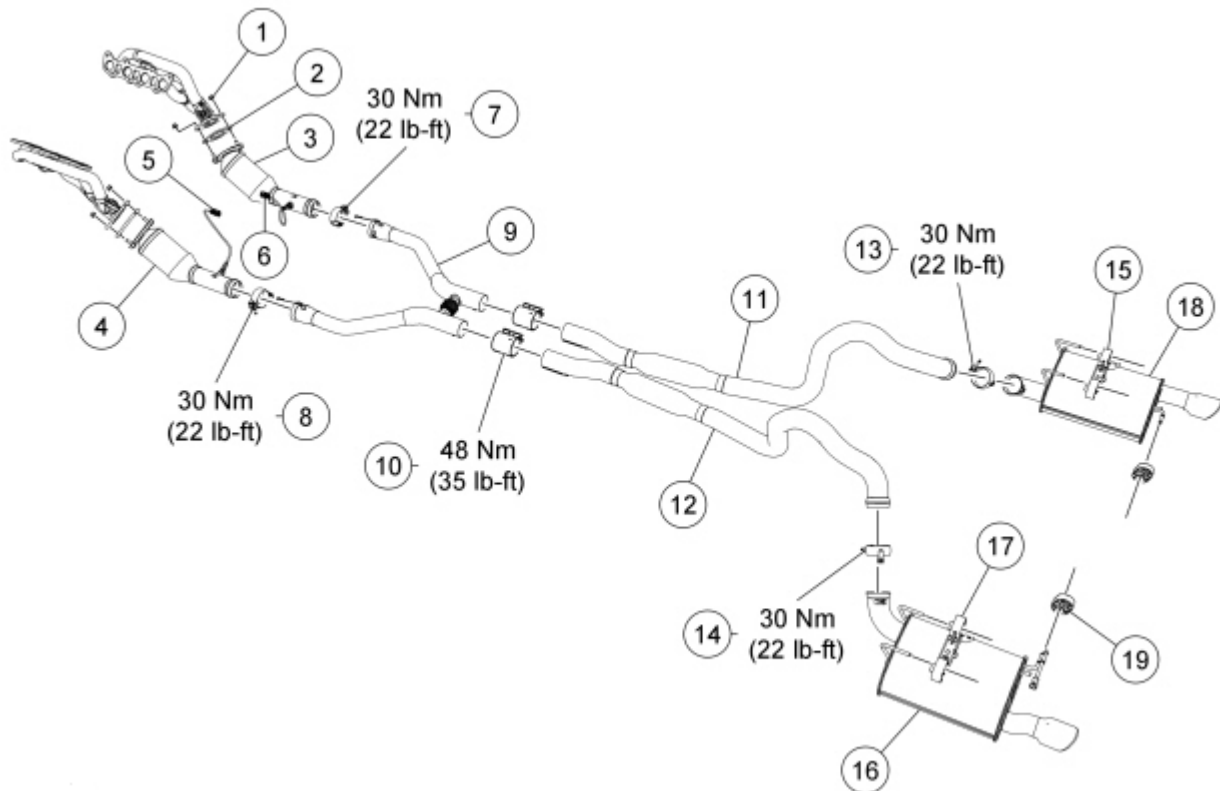

Factory Ford shop manuals are available from Helm Publications, 1-800-782-4356



M-5220-MB 2011-2012 Mustang GT Side Exhaust Kit INSTALLATION INSTRUCTIONS

NO PART OF THIS DOCUMENT MAY BE REPRODUCED WITHOUT PRIOR AGREEMENT AND WRITTEN PERMISSION OF FORD RACING PERFORMANCE PARTS.

Item	Part Number	Description
1	W714265	Catalytic converter-to-exhaust manifold nuts (4 required)
2	5B266	Gasket (2 required)
3	5E212	RH catalytic converter
4	5E213	LH catalytic converter
5	—	LH CMS electrical connector (part of 9G444)
6	—	RH CMS electrical connector (part of 9G444)
7	—	Ball clamp
8	—	Ball clamp
9	5246	Exhaust H-pipe
10	5A281	Torca® coupler (2 required)
11	5A212	RH intermediate pipe
12	5A213	LH intermediate pipe
13	5A231	Ball clamp
14	5A231	Ball clamp
15	5A246	RH front isolator
16	5232	LH muffler assembly
17	5J267	LH front isolator
18	5230	RH muffler assembly
19	5A261	Rear isolator (2 required)

INSTALLATION:

- STEP 1:** Position 2 ball clamps on the catalytic converters.
- STEP 2:** **NOTE:** Using a jackstand, support the exhaust H-pipe in place. Position the exhaust H-pipe in the vehicle.
- STEP 3:** Install the LH and RH catalytic converter-to-exhaust H-pipe ball clamps.
- Do not tighten the ball clamps at this time.

Factory Ford shop manuals are available from Helm Publications, 1-800-782-4356

NO PART OF THIS DOCUMENT MAY BE REPRODUCED WITHOUT PRIOR AGREEMENT AND WRITTEN PERMISSION OF FORD RACING PERFORMANCE PARTS.

STEP 4: **NOTE:** Similar exhaust H-pipe shown.

NOTE: Make sure that the exhaust H-pipe is inserted into the couplers correctly.

Slide the Torca® couplers over exhaust H-pipe outlets and engage the coupler clip completely over the exhaust H-pipe button.

- Do not tighten the Torca® couplers at this time.

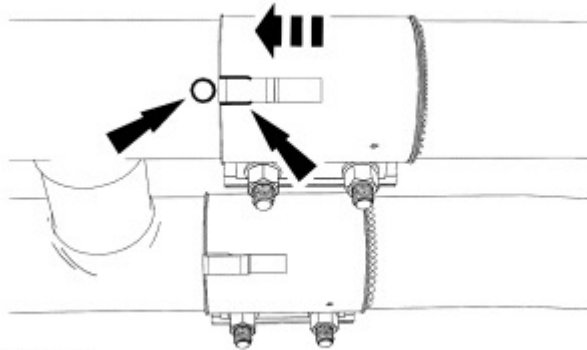

STEP 5: **NOTE:** Make sure to correctly align the exhaust H-pipe to the catalytic converters and intermediate pipes before tightening the fasteners.

NOTE: Position the ball clamp with the bolt hex head facing down and with the bolt tip pointing toward the corner of the rail and underbody before tightening.

Tighten the LH and RH catalytic converter-to-exhaust H-pipe ball clamps.

- Tighten to 30 Nm (22 lb-ft).

STEP 6: Tighten the Torca® couplers.

- Tighten to 48 Nm (35 lb-ft).

STEP 7: **NOTICE:** Do not bend, twist or allow the exhaust side pipes to hang from the flexible bellows or damage to the exhaust side pipe may occur.

Tighten the LH and RH exhaust side pipe bolts. (#2 and #21)

- Insure that the LH and RH exhaust side pipe grommet assemblies are installed (#1 and #20)
- Tighten to 25 Nm (18 lb-ft).

STEP 8: **NOTE:** Install the restrictors, spacers and gaskets in the correct position. (see exploded view)

NOTE: When tightening the side pipe-to-exhaust H-pipe nuts, rotate the side pipe assembly so the pipe after the Torca® clamp has a clearance of 10 mm (0.393 in) to 19 mm (0.748 in) to the flat surface of the floor pan.

Install gaskets, nuts and the LH and RH exhaust side pipes.

- Align the exhaust side pipes and tighten the exhaust side pipe-to-exhaust H-pipe nuts to 40 Nm (30 lb-ft).

M-5220-MB 2011-2012 Mustang GT Side Exhaust Kit INSTALLATION INSTRUCTIONS

NO PART OF THIS DOCUMENT MAY BE REPRODUCED WITHOUT PRIOR AGREEMENT AND WRITTEN PERMISSION OF FORD RACING PERFORMANCE PARTS.

STEP 9: **NOTE:** When tightening the Torca® clamp, make sure the flat section of the side pipes has a clearance of 14 mm (0.551 in) to 23 mm (0.905 in) to the floor pan.

Tighten the exhaust side pipe Torca® clamps.

- Tighten to 48 Nm (35 lb-ft).

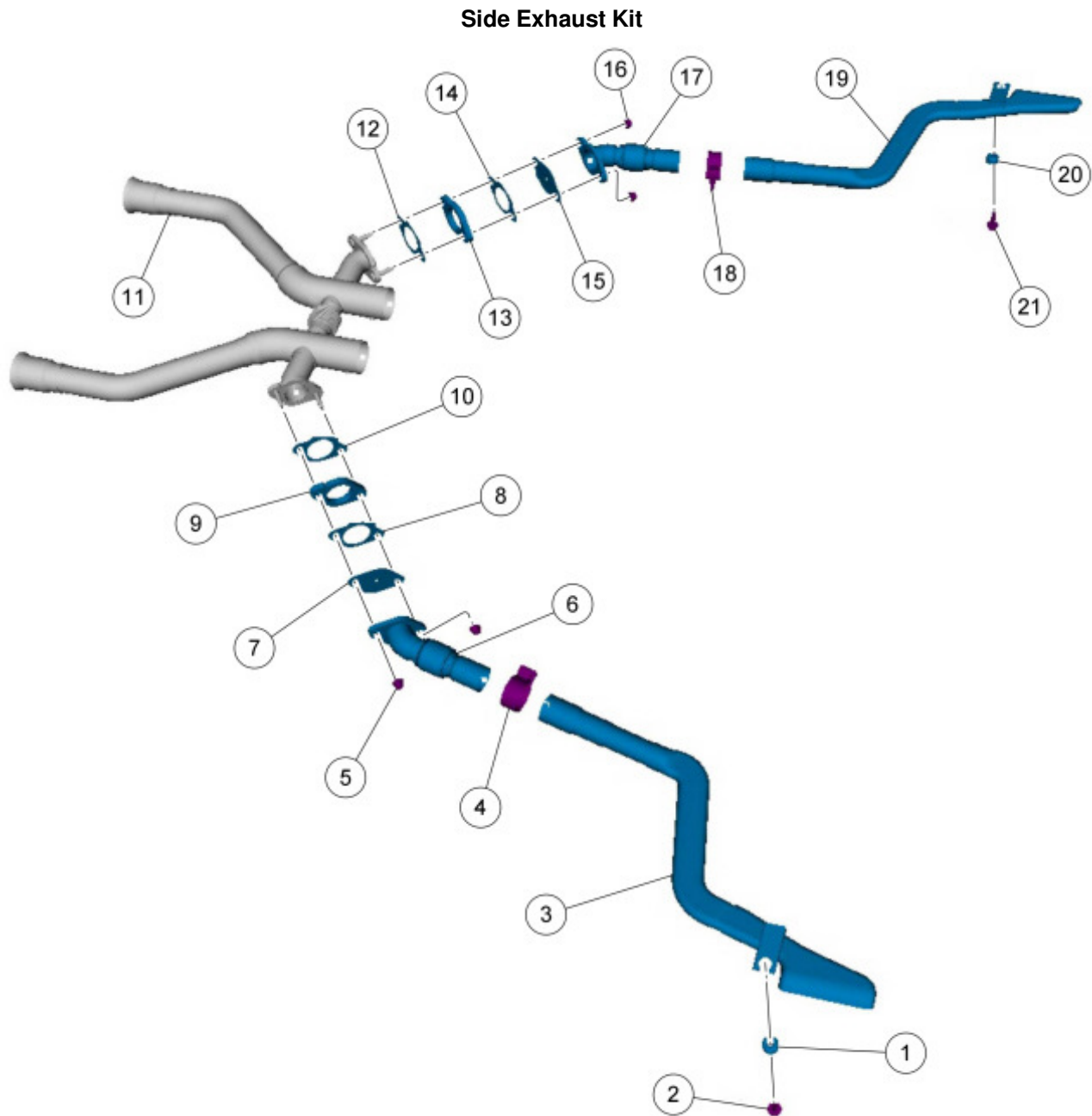

Factory Ford shop manuals are available from Helm Publications, 1-800-782-4356



M-5220-MB 2011-2012 Mustang GT Side Exhaust Kit INSTALLATION INSTRUCTIONS

NO PART OF THIS DOCUMENT MAY BE REPRODUCED WITHOUT PRIOR AGREEMENT AND WRITTEN PERMISSION OF FORD RACING PERFORMANCE PARTS.

Item	Part Number	Description
1	17C431	LH exhaust side pipe grommet assembly
2	W714780	LH exhaust side pipe bolt - 25 Nm (18 lb-ft)
3	5255	LH exhaust side pipe
4	—	LH exhaust side pipe Torca® clamp (part of 5255) - 48 Nm (35 lb-ft)
5	W705443	LH exhaust side pipe-to-exhaust H-pipe nut (2 required) - 40 Nm (30 lb-ft)
6	5255	LH exhaust side pipe flange (part of 5255)
7	5C226	Restrictor
8	5B266	Gasket
9	5H294	Spacer
10	5B266	Gasket
11	5246	Exhaust H-Pipe
12	5B266	Gasket
13	5H294	Spacer
14	5B266	Gasket
15	5C226	Restrictor
16	W705443	RH exhaust side pipe-to-exhaust H-pipe nut (2 required) - 40 Nm (30 lb-ft)
17	5255	RH exhaust side pipe flange (part of 5255)
18	—	RH exhaust side pipe Torca® clamp (part of 5255) - 48 Nm (35 lb-ft)
19	5255	RH exhaust side pipe
20	17C431	RH exhaust side pipe grommet assembly
21	W714780	RH exhaust side pipe bolt - 25 Nm (18 lb-ft)

Factory Ford shop manuals are available from Helm Publications, 1-800-782-4356