



M-16600-S65D
2024+MY Mustang Coupe
Spoiler Delete Kit

NO PART OF THIS DOCUMENT MAY BE REPRODUCED WITHOUT PRIOR AGREEMENT AND WRITTEN PERMISSION OF
FORD PERFORMANCE PARTS © Ford Motor Company 2020

PRIOR TO INSTALLATION READ THESE INSTRUCTION COMPETELY
For questions, Call the FORD PERFORMANCE Techline 1-800-367-3788

Please visit <https://www.performanceparts.ford.com> for warranty information

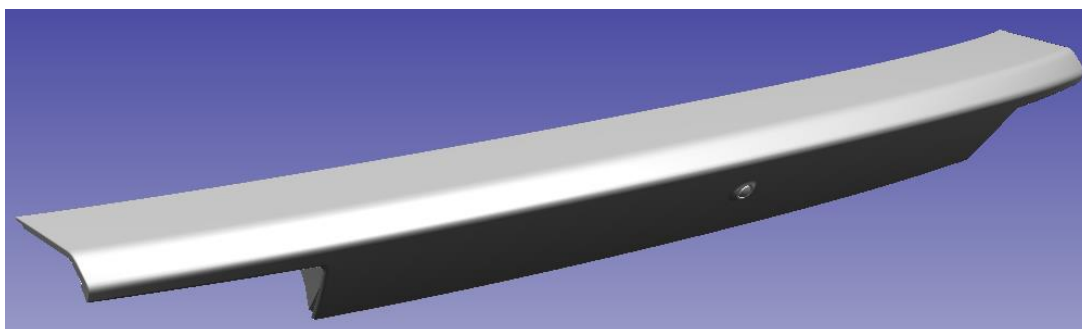





Ford Factory Shop Manual purchase options www.motorcraftservice.com

NO PART OF THIS DOCUMENT MAY BE REPRODUCED WITHOUT PRIOR AGREEMENT AND WRITTEN PERMISSION OF
 FORD PERFORMANCE PARTS © Ford Motor Company 2020

Kit Contents:

Description	Quantity
Outer Non-spoiler Module	1
Inner Non-spoiler Module	1
Rear View Camera Assembly	1
Spoiler Module Hardware/Adhesive Kit	1
Tub Clips	2

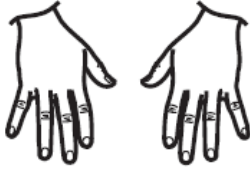
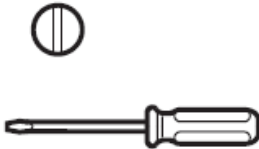
Special Tool(s) / General Equipment:

Ford Factory Shop Manual purchase options www.motorcraftservice.com

NO PART OF THIS DOCUMENT MAY BE REPRODUCED WITHOUT PRIOR AGREEMENT AND WRITTEN PERMISSION OF
FORD PERFORMANCE PARTS © Ford Motor Company 2020

Removal

NOTE: Removal steps in this procedure may contain installation details.

1. Remove the luggage compartment lid emergency release handle.
 1. Press down the luggage compartment lid emergency release handle retaining tab.
 2. Remove the luggage compartment lid emergency release handle.



E406206

NO PART OF THIS DOCUMENT MAY BE REPRODUCED WITHOUT PRIOR AGREEMENT AND WRITTEN PERMISSION OF
FORD PERFORMANCE PARTS © Ford Motor Company 2020

2. Remove the luggage compartment lid latch cover.
 1. Insert a flat blade screwdriver between the luggage compartment lid latch cover and luggage compartment lid latch.
 2. Remove the luggage compartment lid latch cover while gently prying the cover away from the luggage compartment lid latch disengaging the luggage compartment lid latch cover from the tab on luggage compartment lid latch.

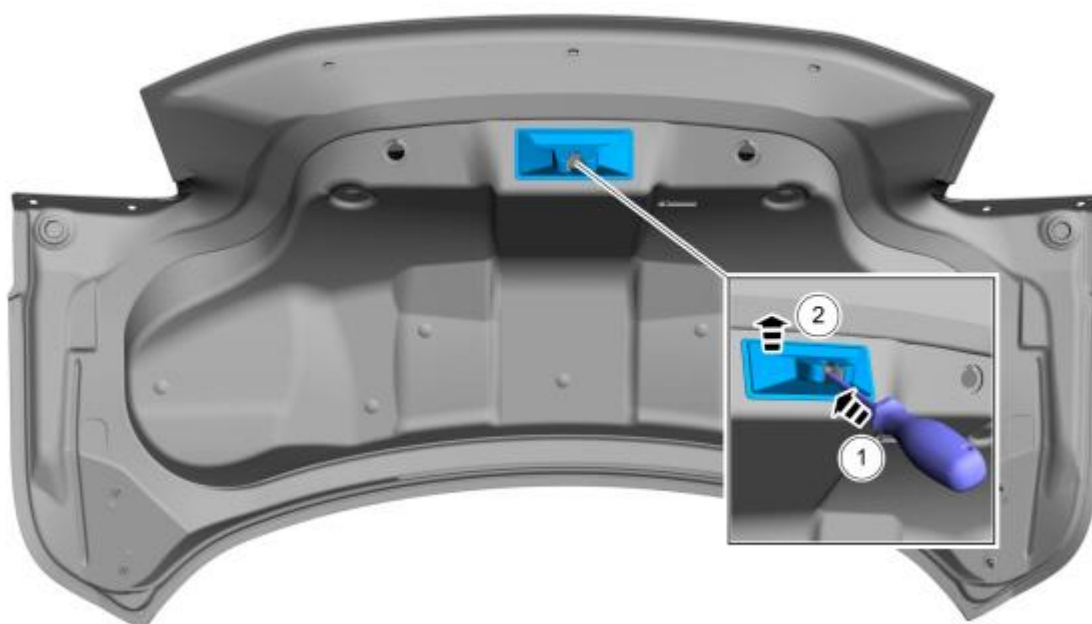

E406207

NO PART OF THIS DOCUMENT MAY BE REPRODUCED WITHOUT PRIOR AGREEMENT AND WRITTEN PERMISSION OF
FORD PERFORMANCE PARTS © Ford Motor Company 2020

3. **NOTE:** *Coupe shown others are similar.*

1. Remove the rubber grommets.
2. Remove the retainers and the luggage compartment lid trim panel.

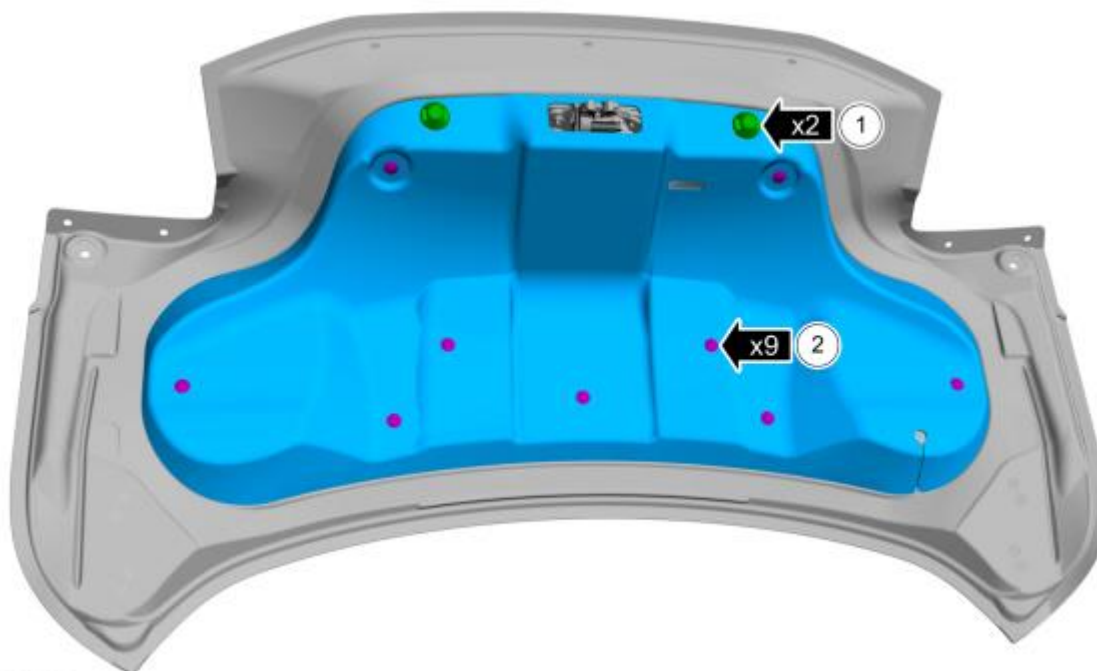

E406208

Ford Factory Shop Manual purchase options www.motorcraftservice.com

NO PART OF THIS DOCUMENT MAY BE REPRODUCED WITHOUT PRIOR AGREEMENT AND WRITTEN PERMISSION OF
FORD PERFORMANCE PARTS © Ford Motor Company 2020

- 4.
1. Remove the bolts.
Torque: 22 lb.in (2.5 Nm)
 2. Remove the nuts.
Torque: 49 lb.in (5.5 Nm)

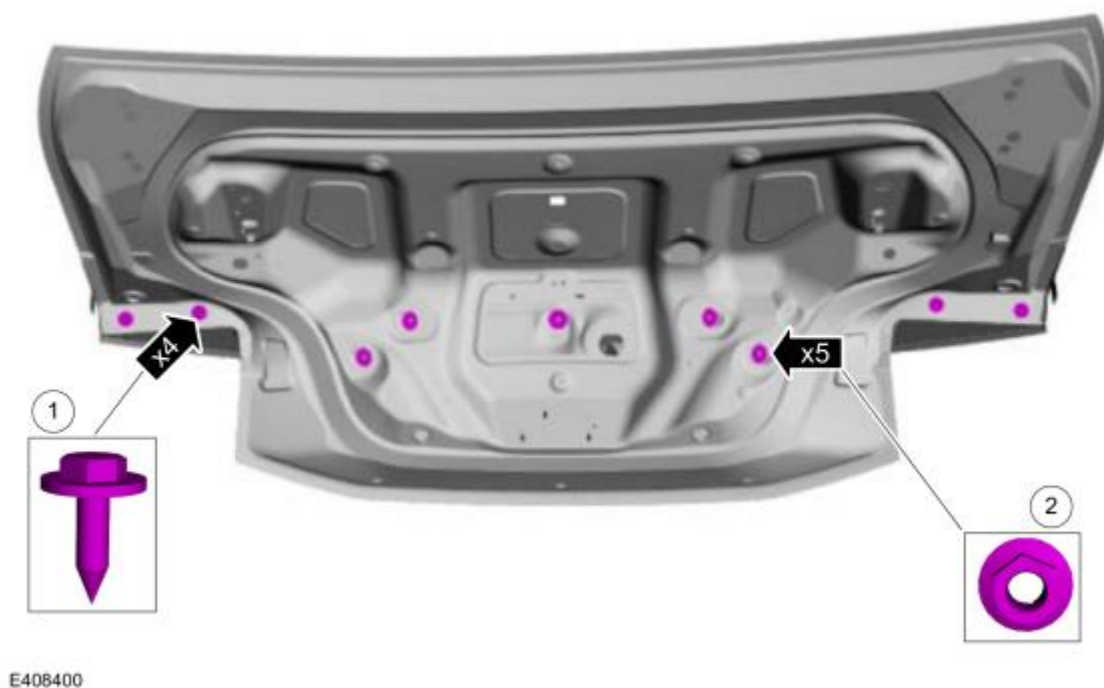

NO PART OF THIS DOCUMENT MAY BE REPRODUCED WITHOUT PRIOR AGREEMENT AND WRITTEN PERMISSION OF
FORD PERFORMANCE PARTS © Ford Motor Company 2020

Vehicle Equipped With Only Lower Spoiler

NOTE: The rear spoiler uses two-side adhesive tape to fasten the spoiler to the luggage compartment panel.

5.
 - Release the rear spoiler clips from body panel.
 - Disconnect the electrical connector and remove the rear spoiler.

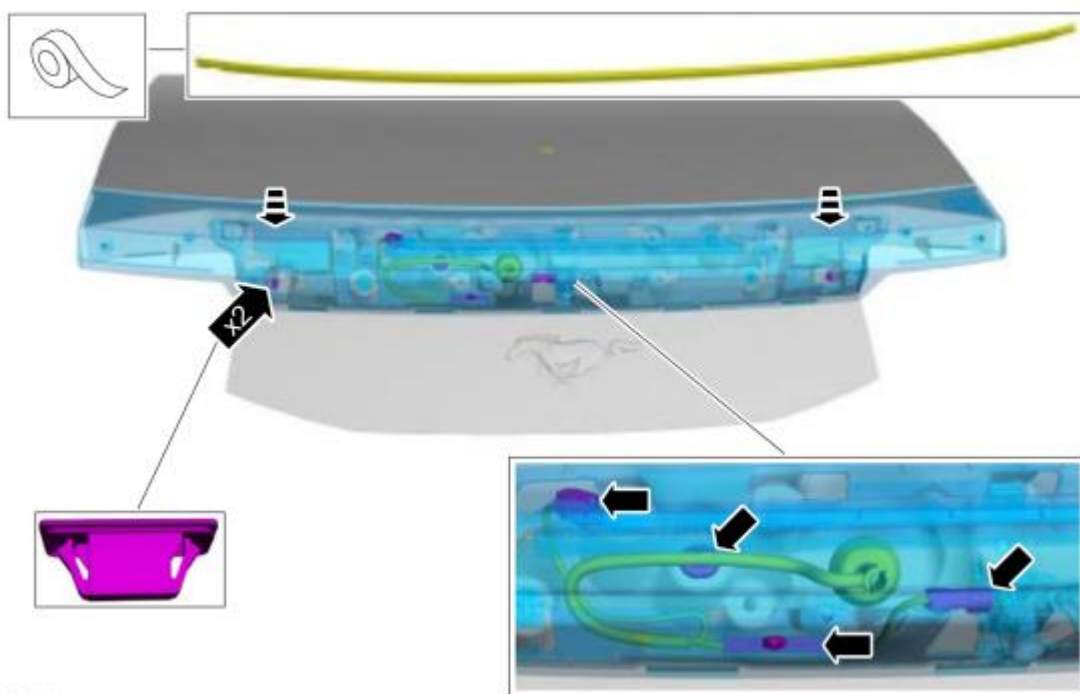

E408401

Ford Factory Shop Manual purchase options www.motorcraftservice.com

NO PART OF THIS DOCUMENT MAY BE REPRODUCED WITHOUT PRIOR AGREEMENT AND WRITTEN PERMISSION OF
FORD PERFORMANCE PARTS © Ford Motor Company 2020

6. If equipped.
- Remove the bolts.
 - Release the fasteners and remove the luggage compartment extend panel.

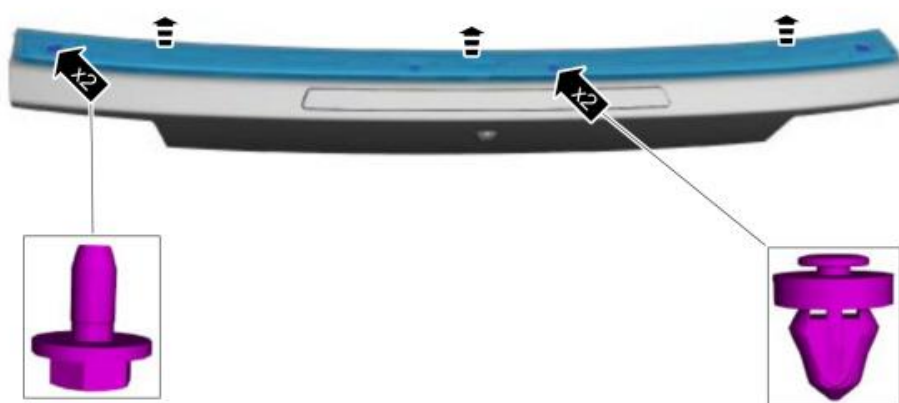

E408709

7. Clean any residual adhesive and dirt from the luggage compartment panel surface.



E408688

Ford Factory Shop Manual purchase options www.motorcraftservice.com

NO PART OF THIS DOCUMENT MAY BE REPRODUCED WITHOUT PRIOR AGREEMENT AND WRITTEN PERMISSION OF
FORD PERFORMANCE PARTS © Ford Motor Company 2020

Vehicle equipped with upper and lower spoiler

NOTE: The rear spoiler uses two-side adhesive tape to fasten the spoiler to the luggage compartment panel.

- 8.
- Release the rear spoiler clips from body panel.
 - Disconnect the electrical connector and remove the rear spoiler.

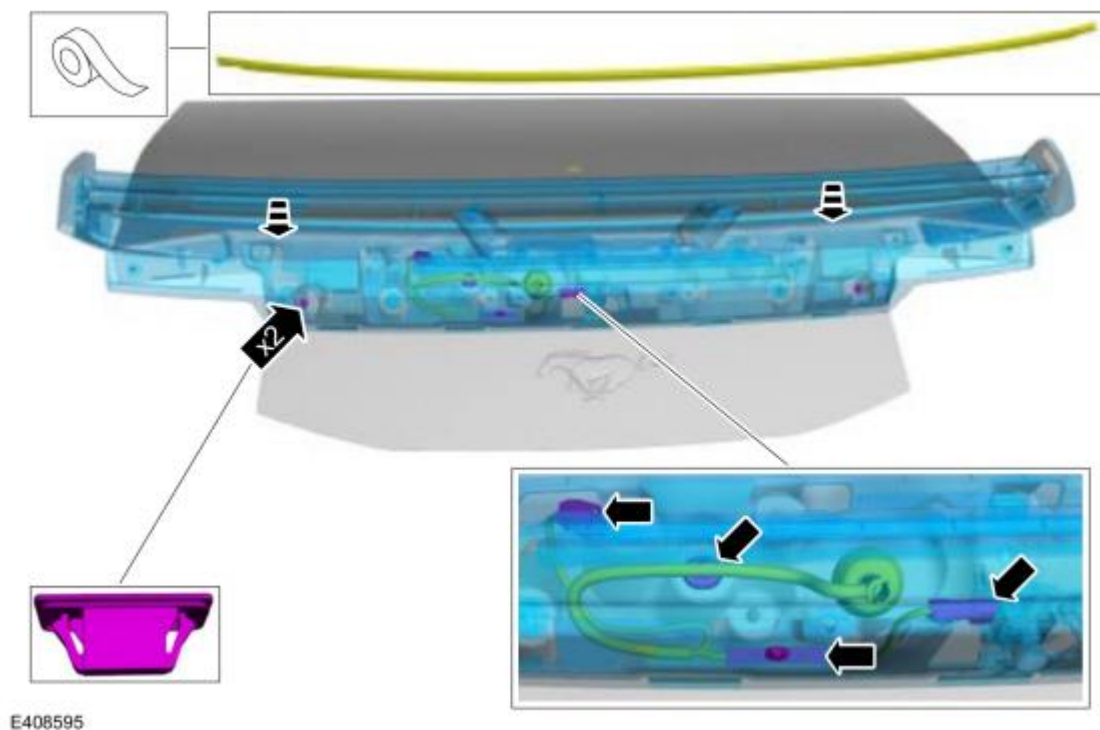

NO PART OF THIS DOCUMENT MAY BE REPRODUCED WITHOUT PRIOR AGREEMENT AND WRITTEN PERMISSION OF
FORD PERFORMANCE PARTS © Ford Motor Company 2020

9. If necessary.
Remove the bolts and rear upper spoiler from lower spoiler assembly.
Torque: 71 lb.in (8 Nm)

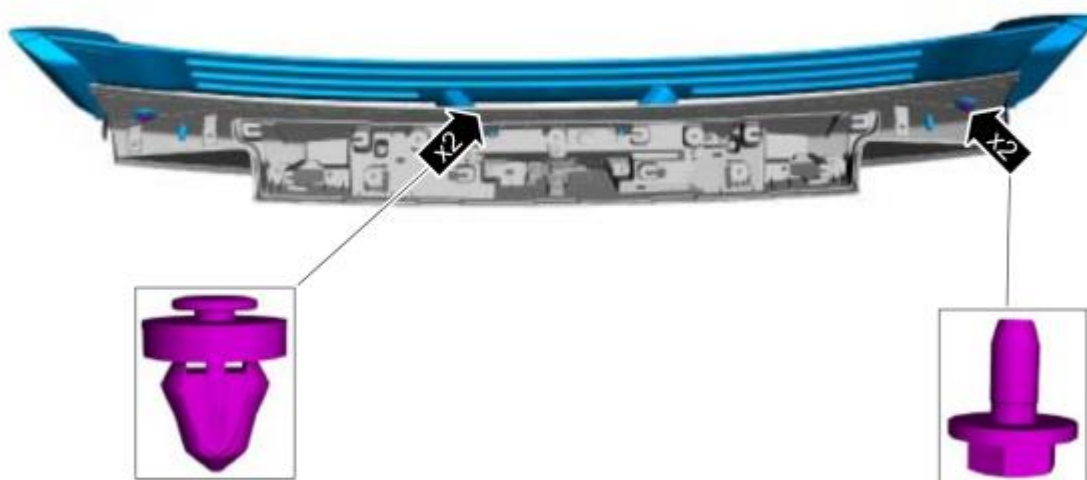

E408596

NO PART OF THIS DOCUMENT MAY BE REPRODUCED WITHOUT PRIOR AGREEMENT AND WRITTEN PERMISSION OF
FORD PERFORMANCE PARTS © Ford Motor Company 2020

Installation

NOTE: Before applying any component with adhesive to the spoiler module, ensure the surface is clean by using an alcohol wipe then let dry.

1. Install ten nut clips to the outer spoiler module.

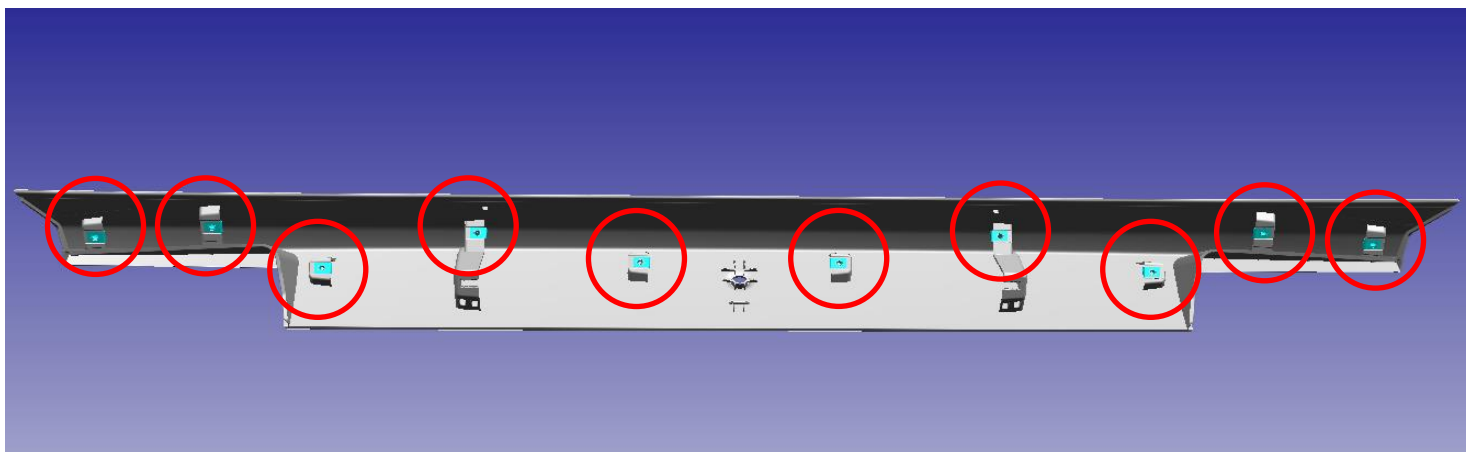

2. Remove the red protective backing from the nine rubber seals and install to the outer spoiler module.



3. Remove the brown protective backing from the foam rectangles and install to the outer spoiler module.

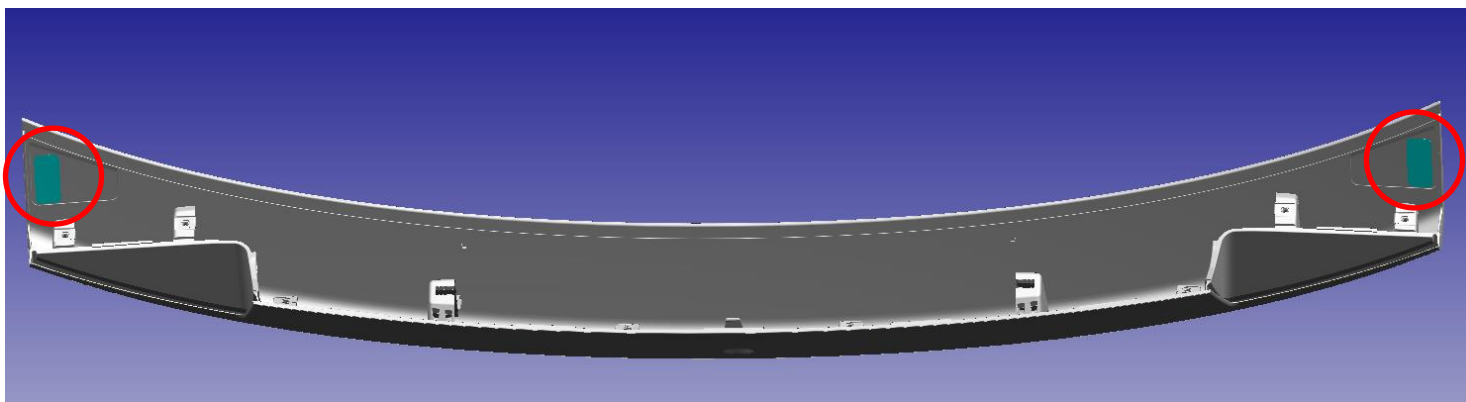

Ford Factory Shop Manual purchase options www.motorcraftservice.com

NO PART OF THIS DOCUMENT MAY BE REPRODUCED WITHOUT PRIOR AGREEMENT AND WRITTEN PERMISSION OF
FORD PERFORMANCE PARTS © Ford Motor Company 2020

4. Remove the brown protective backing from the two-sided tape and install as shown below. Do not remove the red protective backing at this step.

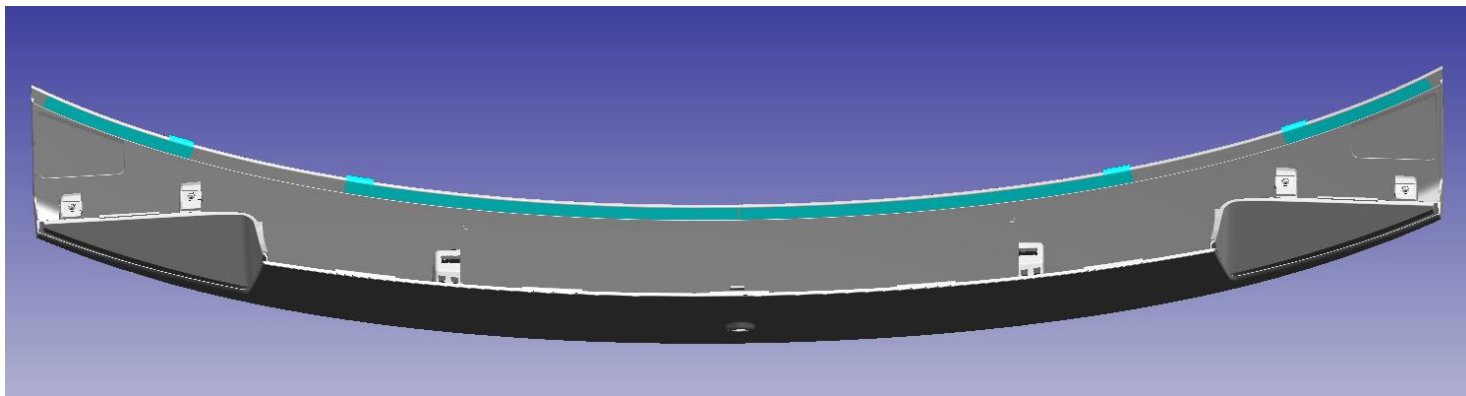

5. Place the inner module into the outer spoiler module. Make sure the inner module clips in on both sides. RH side shown, LH side similar.

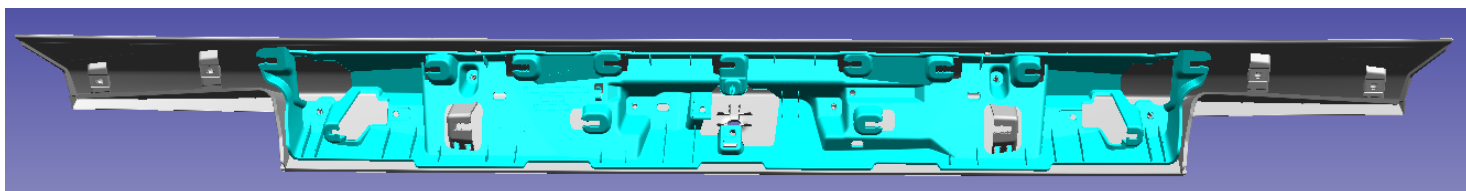
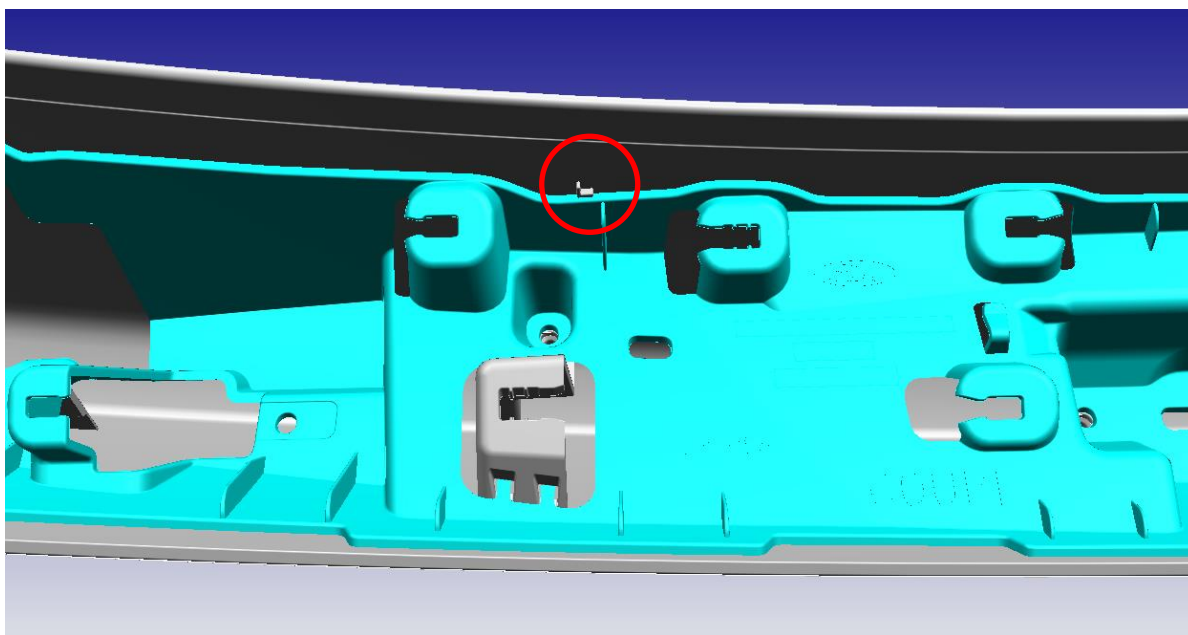

Ford Factory Shop Manual purchase options www.motorcraftservice.com

NO PART OF THIS DOCUMENT MAY BE REPRODUCED WITHOUT PRIOR AGREEMENT AND WRITTEN PERMISSION OF
FORD PERFORMANCE PARTS © Ford Motor Company 2020

6. Use six screws to install the inner module to the outer module.

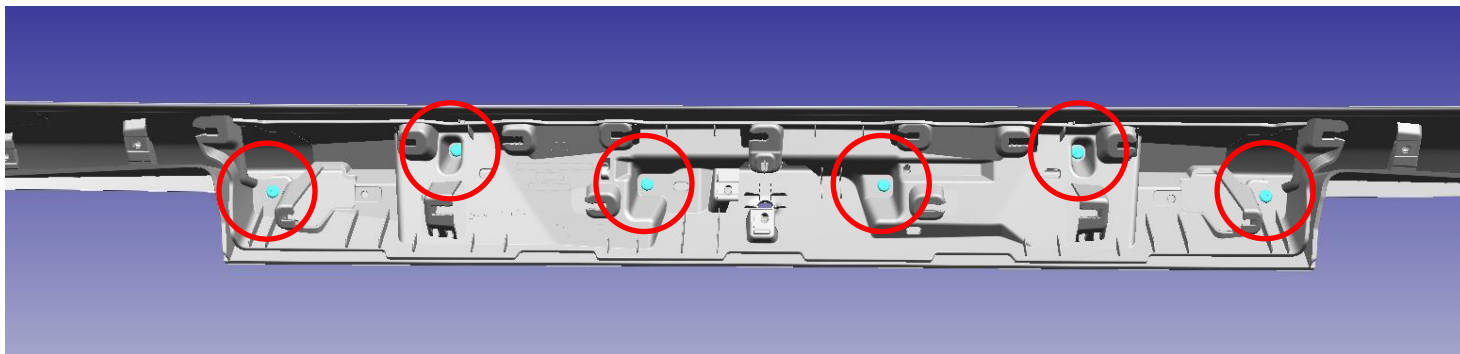

7. Remove the protective backing from the clip foam and install as shown below.

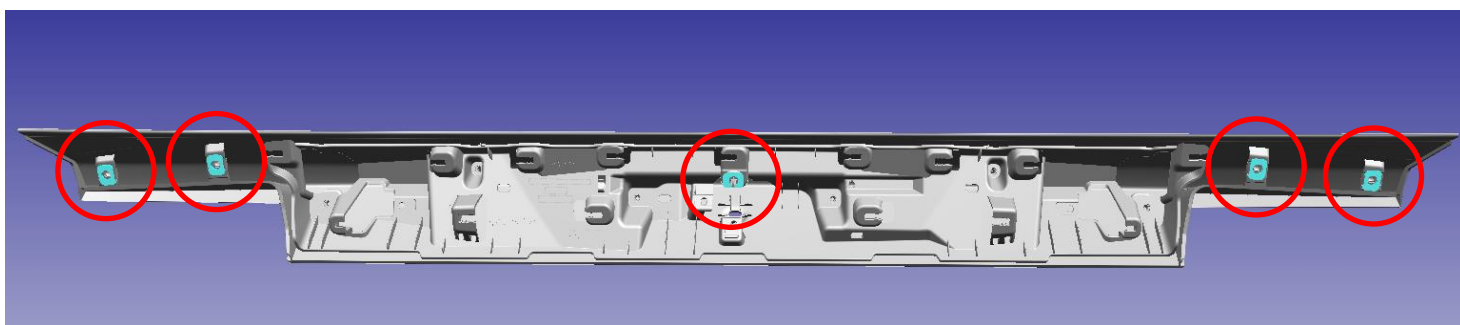

8. Install five T-studs with foam to the spoiler module. Make sure T-studs clip in.

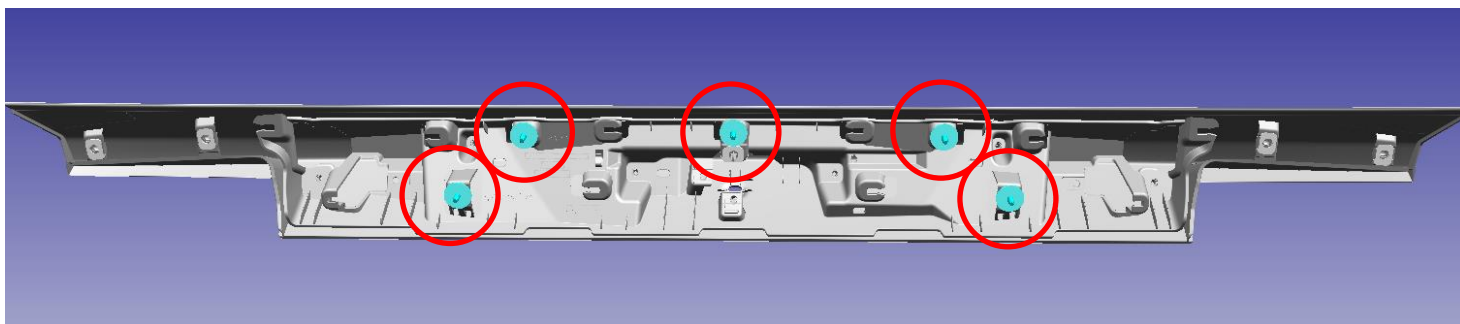

NO PART OF THIS DOCUMENT MAY BE REPRODUCED WITHOUT PRIOR AGREEMENT AND WRITTEN PERMISSION OF
FORD PERFORMANCE PARTS © Ford Motor Company 2020

9. Install two nut clips as shown below.

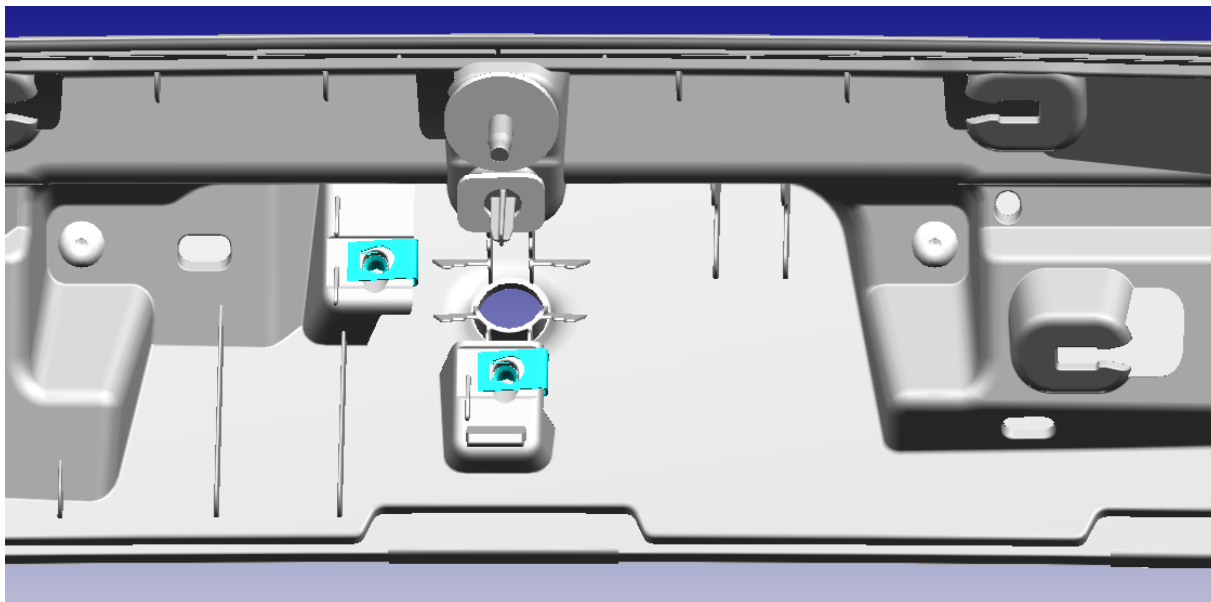

10. Place the camera as shown below.

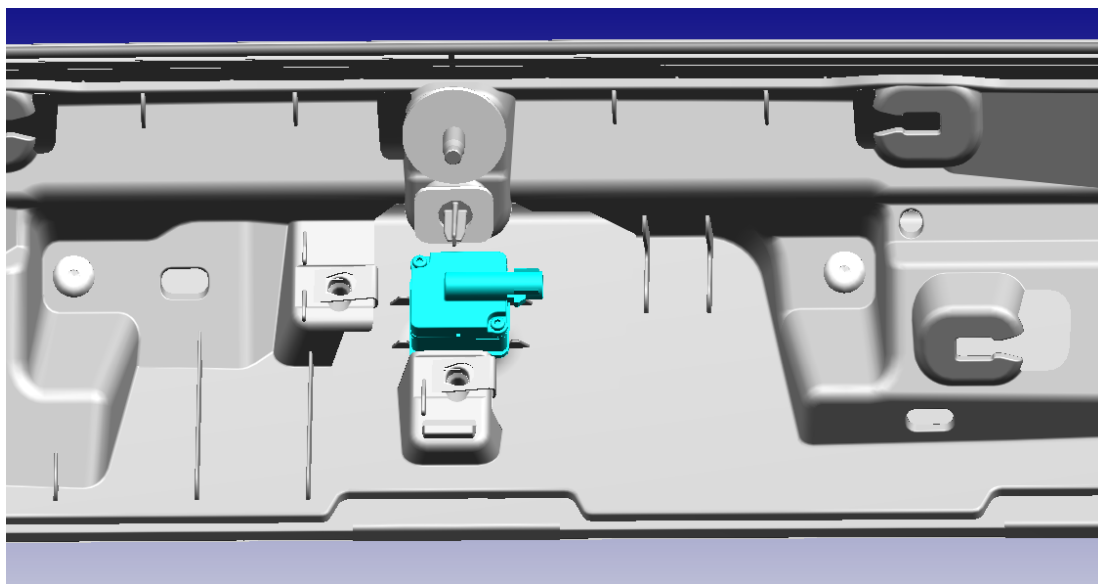

Ford Factory Shop Manual purchase options www.motorcraftservice.com

NO PART OF THIS DOCUMENT MAY BE REPRODUCED WITHOUT PRIOR AGREEMENT AND WRITTEN PERMISSION OF
FORD PERFORMANCE PARTS © Ford Motor Company 2020

11. Place the camera housing onto the inner spoiler module. Make sure the three locator tabs line up properly with the camera housing.

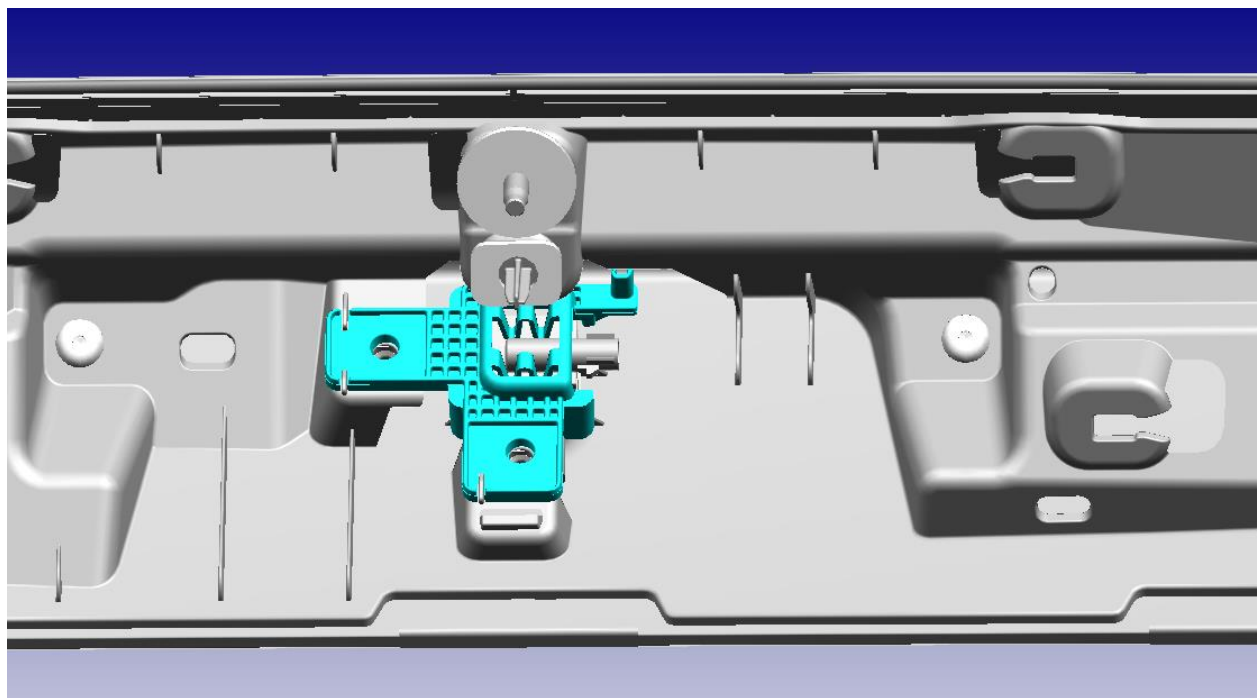

12. Use two screws to secure the camera housing.

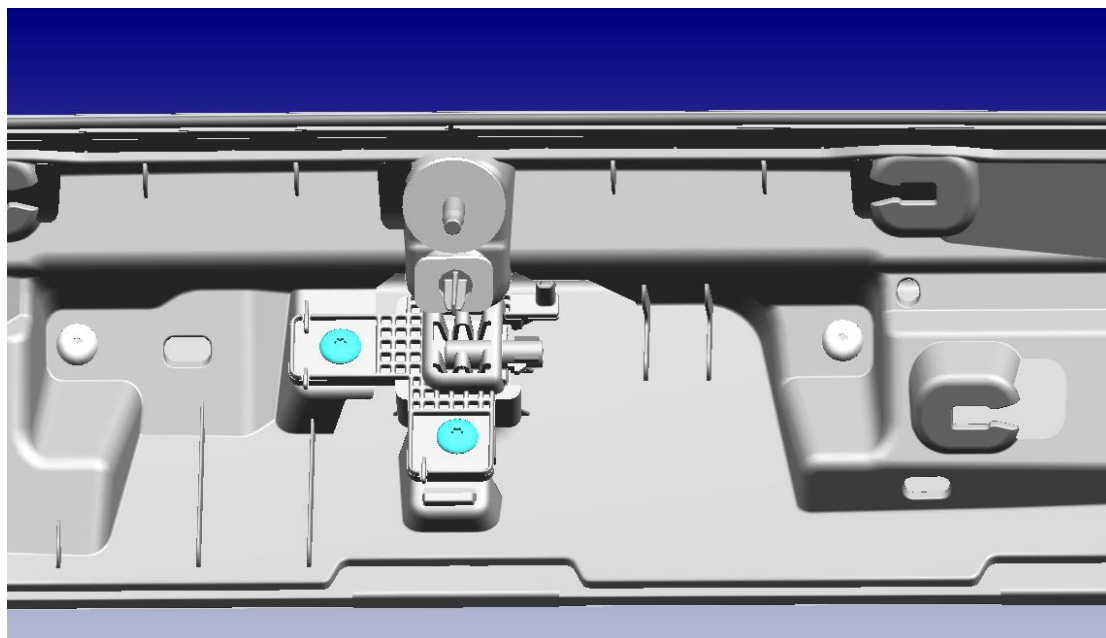

Ford Factory Shop Manual purchase options www.motorcraftservice.com

NO PART OF THIS DOCUMENT MAY BE REPRODUCED WITHOUT PRIOR AGREEMENT AND WRITTEN PERMISSION OF
FORD PERFORMANCE PARTS © Ford Motor Company 2020

13. Install a trim pin on both sides. RH side shown, LH side similar.

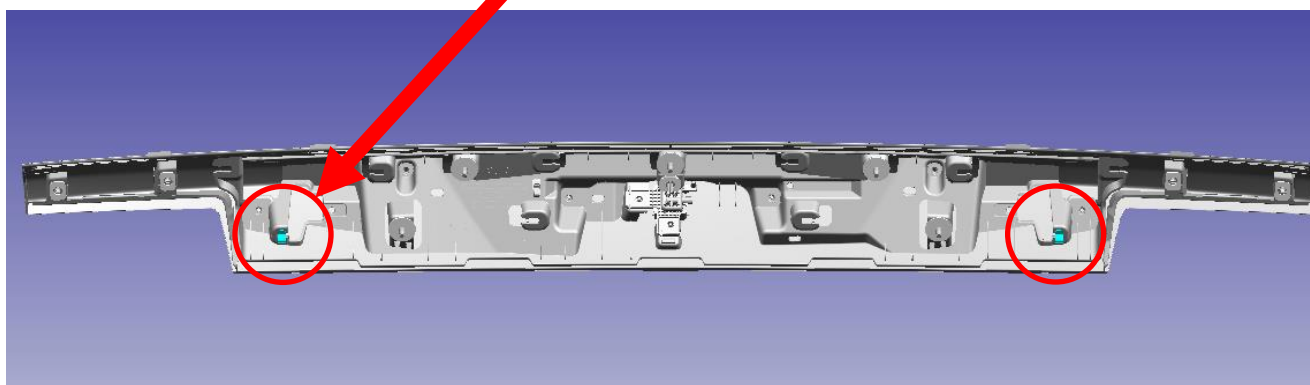
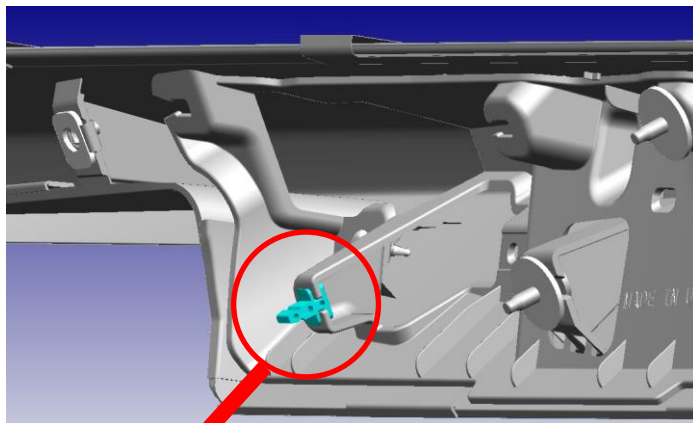

14. Install a tub clip onto the trim pins on both sides.

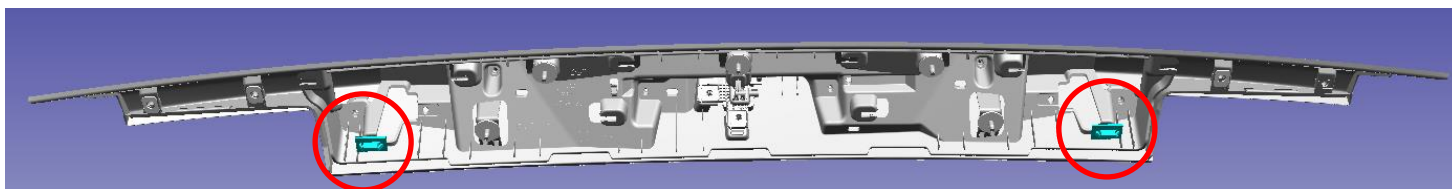

15. **NOTE:** Before installing the non-spoiler module onto the luggage compartment panel, remove the red protective backing from the two-sided tape.
NOTE: When installing the spoiler, apply approximately 15 lbs. of pressure along the length of the spoiler to ensure adhesion of the two-sided tape.

To install, reverse the removal procedure.

16. Using a diagnostic scan tool to initialize the parking aid camera, select the controlling module for the parking aid camera(s).

Ford Factory Shop Manual purchase options www.motorcraftservice.com



M-16600-S65D 2024+MY Mustang Coupe Spoiler Delete Kit

NO PART OF THIS DOCUMENT MAY BE REPRODUCED WITHOUT PRIOR AGREEMENT AND WRITTEN PERMISSION OF
FORD PERFORMANCE PARTS © Ford Motor Company 2020

17. Refer to the wiring diagram to identify the camera controlling module.
Refer to Wiring Diagrams Cell [145](#) for schematic and connector information.
18. Select the controlling module on the diagnostic scan tool screen.
19. Carry out the LIN new module initialization.
20. Follow the on-screen instructions.
21. Check the vehicle for the active guidelines option. Refer to description and operation in the appropriate vehicle section.
22. If equipped with active guidelines, drive the vehicle on a flat, smooth road at 32 km/h (20 mph) or more, with hands placed loosely on the steering wheel and minimal steering correction for approximately 30 seconds.

Ford Factory Shop Manual purchase options www.motorcraftservice.com