

NO PART OF THIS DOCUMENT MAY BE REPRODUCED WITHOUT PRIOR AGREEMENT AND WRITTEN PERMISSION OF  
FORD PERFORMANCE PARTS

**PRIOR TO INSTALLATION READ THESE INSTRUCTION COMPLETELY**  
For questions, Call the FORD PERFORMANCE Techline 1-800-367-3788

Please visit <https://www.performanceparts.ford.com> for warranty information

## Warn Winch Kit

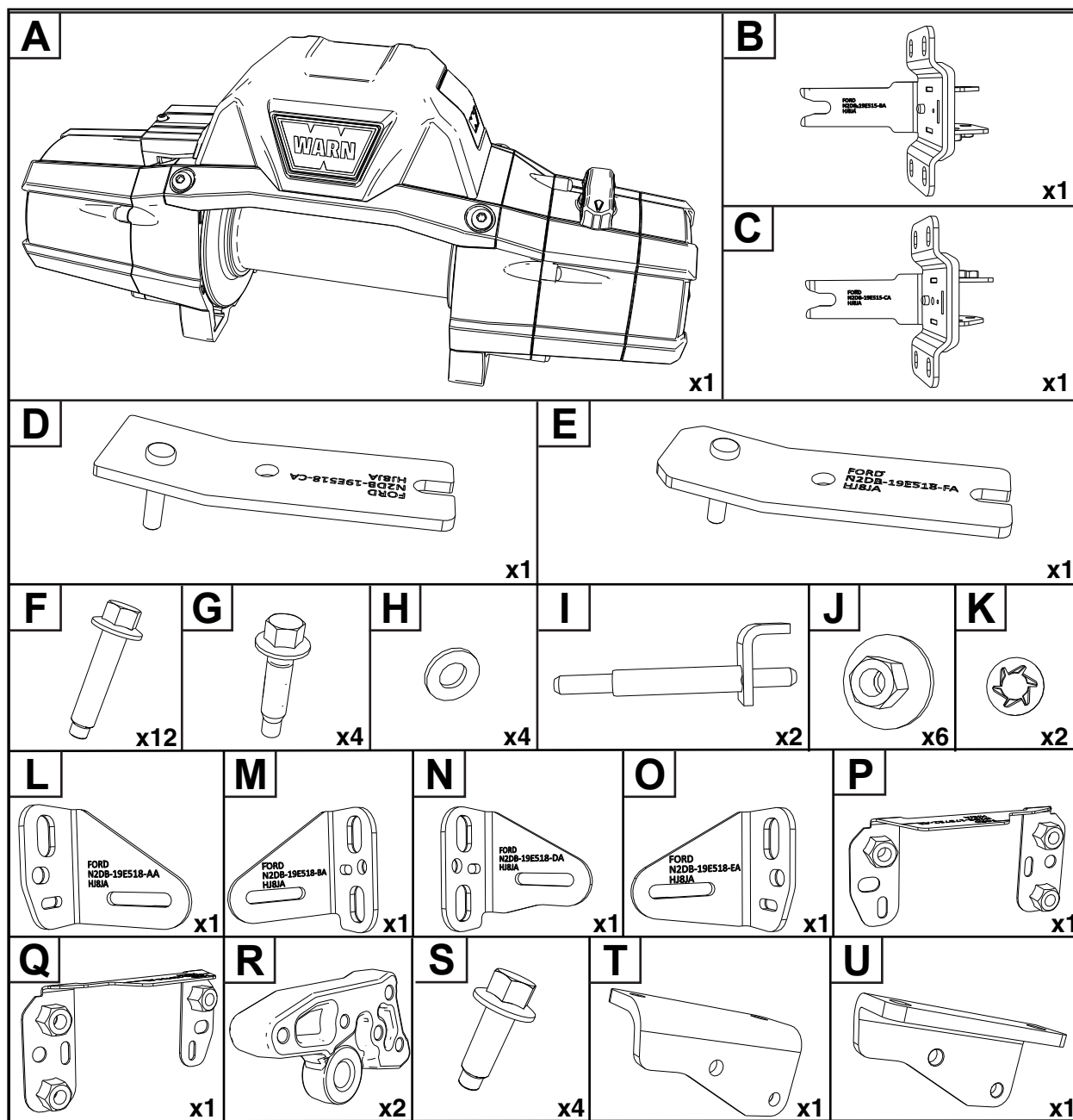

Ford Factory Shop Manual purchase options [www.motorcraftservice.com](http://www.motorcraftservice.com)

NO PART OF THIS DOCUMENT MAY BE REPRODUCED WITHOUT PRIOR AGREEMENT AND WRITTEN PERMISSION OF  
FORD PERFORMANCE PARTS

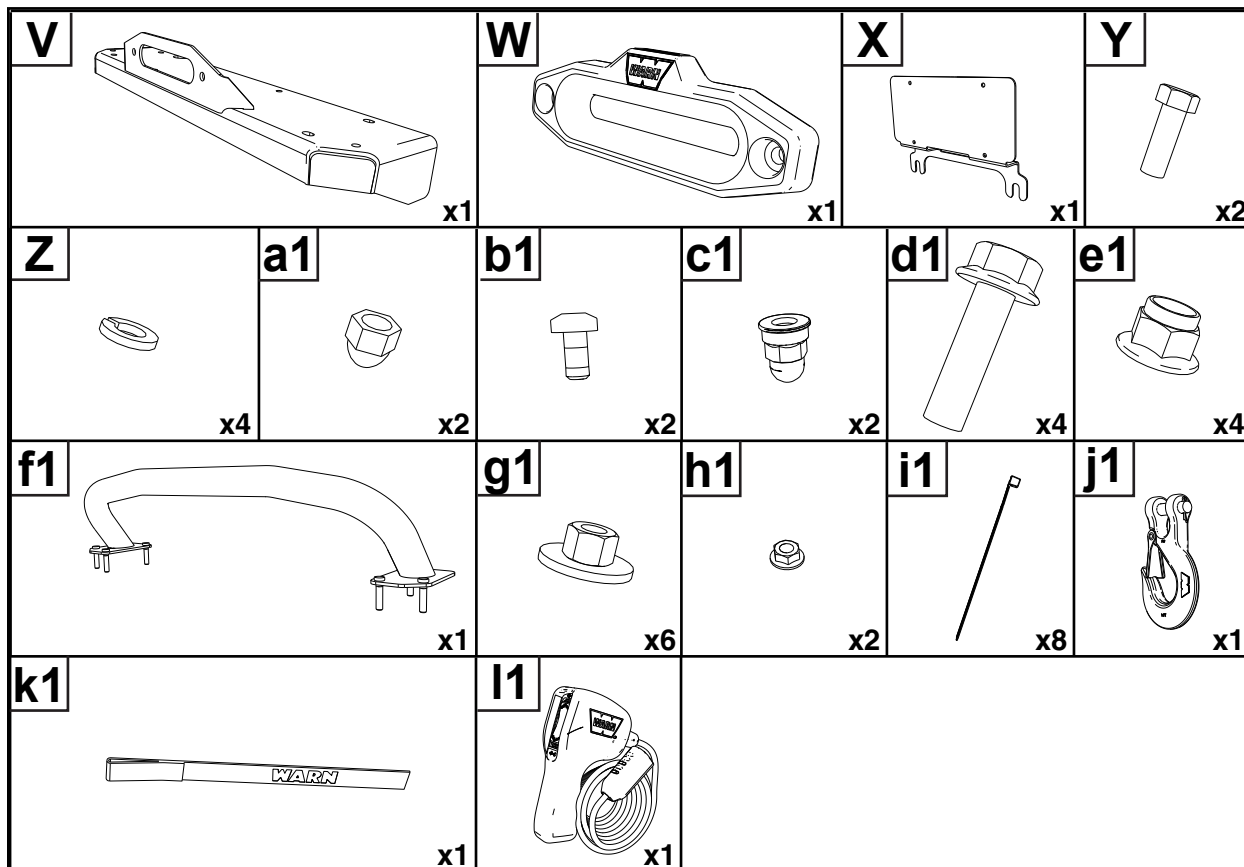

Kit Contents	Description
A	Winch
B	Clevis Bracket (Left Hand)
C	Clevis Bracket (Right Hand)
D	CAC Bracket (Left Hand)
E	CAC Bracket (Right Hand)
F	Outer Frame Bolt
G	CAC Bracket Bolt
H	CAC Bracket Washer
I	Inner Frame Bolt
J	Frame Bracket Nut
K	Tinnerman Nut
L	Outer Frame Bracket (Left Hand)

Ford Factory Shop Manual purchase options [www.motorcraftservice.com](http://www.motorcraftservice.com)



M-1821-B  
2021 →  
Bronco Off-Road Winch

NO PART OF THIS DOCUMENT MAY BE REPRODUCED WITHOUT PRIOR AGREEMENT AND WRITTEN PERMISSION OF  
FORD PERFORMANCE PARTS

Kit Contents	Description
M	Inner Frame Bracket (Left Hand)
N	Inner Frame Bracket (Right Hand)
O	Outer Frame Bracket (Right Hand)
P	Frame Nut Plate (Left Hand)
Q	Frame Nut Plate (Right Hand)
R	Recovery Forging
S	Recovery Forging Bracket Bolt
T	Recovery Forging Bracket (Left Hand)
U	Recovery Forging Bracket (Right Hand)
V	Winch Plate
W	Fair Lead
X	License Plate Kit (Optional)
Y	Fairlead Bolt
Z	Fairlead Washer
a1	Fairlead Nut
b1	License Plate Bolt
c1	License Plate Nut
d1	Winch Housing Bolt
e1	Winch Housing Nut
f1	Brush Bar
g1	Brush Bar Nut
h1	Nut
i1	Tie Strap
j1	Hook
k1	Hook Strap
l1	Winch Remote

Tools Required	
Push Pin Removal Tool	Ratchet
15mm Socket	8mm Socket
Torque Wrench	5/8 Socket
10mm Socket	FDRS & VCM II

Ford Factory Shop Manual purchase options [www.motorcraftservice.com](http://www.motorcraftservice.com)

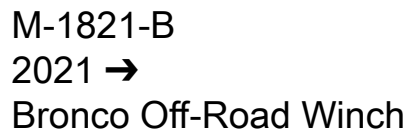

## INSTALLATION PROCEDURE - Winch Kit

[illegible]

- 
- Diagram illustrating the removal of the front fender. Four screws are indicated for removal with dashed lines and arrows. A legend shows a screwdriver and a 15 mm hex key.

IS M-1821-B 082521

NO PART OF THIS DOCUMENT MAY BE REPRODUCED WITHOUT PRIOR AGREEMENT AND WRITTEN PERMISSION OF  
FORD PERFORMANCE PARTS

2. Remove the push pin retainers.

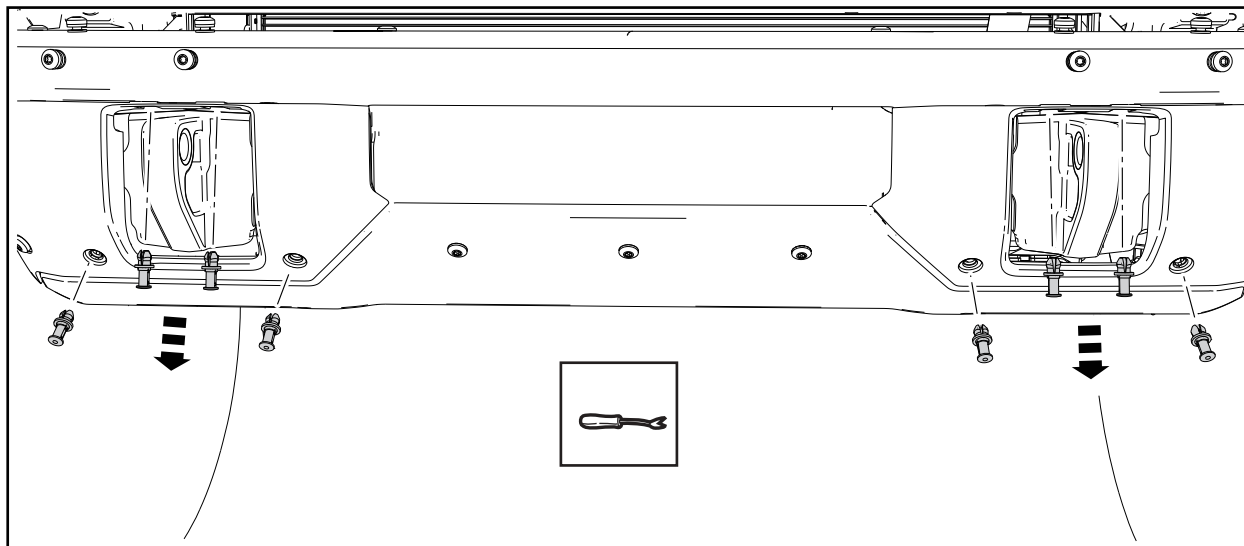

3. Remove the front bumper trim panel.

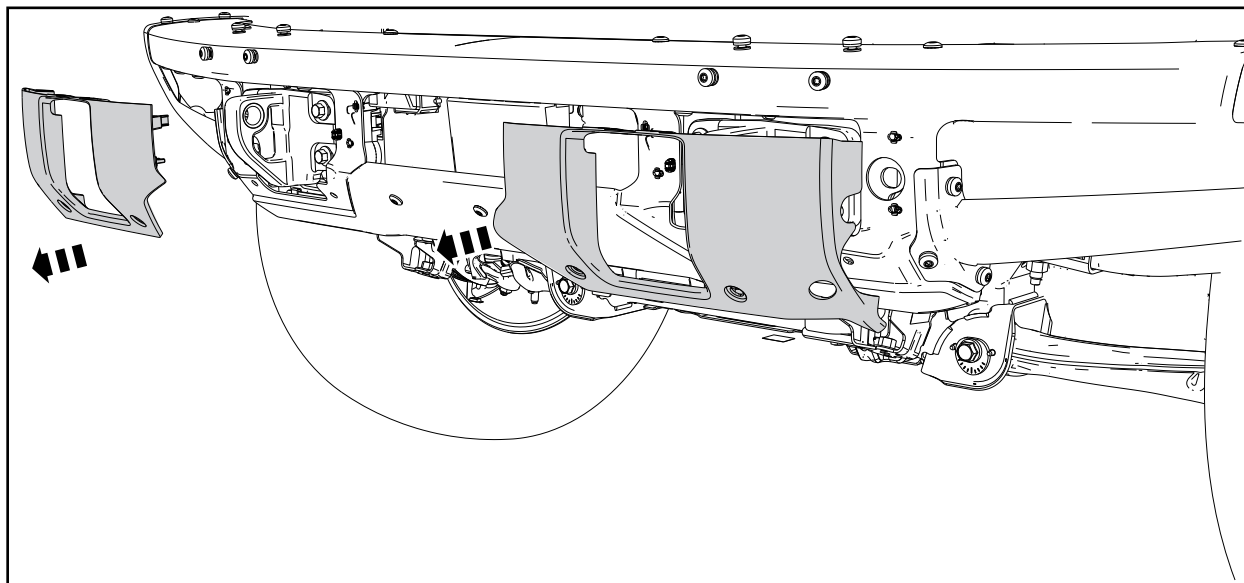

NO PART OF THIS DOCUMENT MAY BE REPRODUCED WITHOUT PRIOR AGREEMENT AND WRITTEN PERMISSION OF  
FORD PERFORMANCE PARTS

**NOTE:** This step requires the aid of another person.

4. Remove the front bumper bolts.

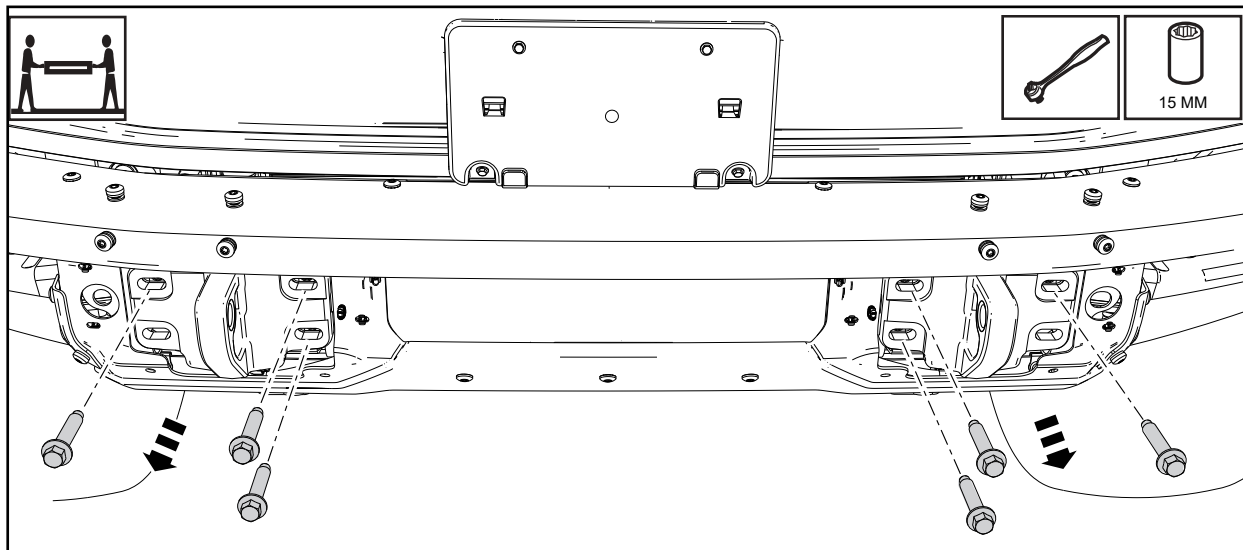

**NOTE:** This step requires the aid of another person.

**NOTE:** If the bumper is equipped with a safari bar it must be removed before proceeding. The mounting bolts should be reinstalled and torqued to 18 lb.ft (25 Nm).

5. Remove the front bumper.

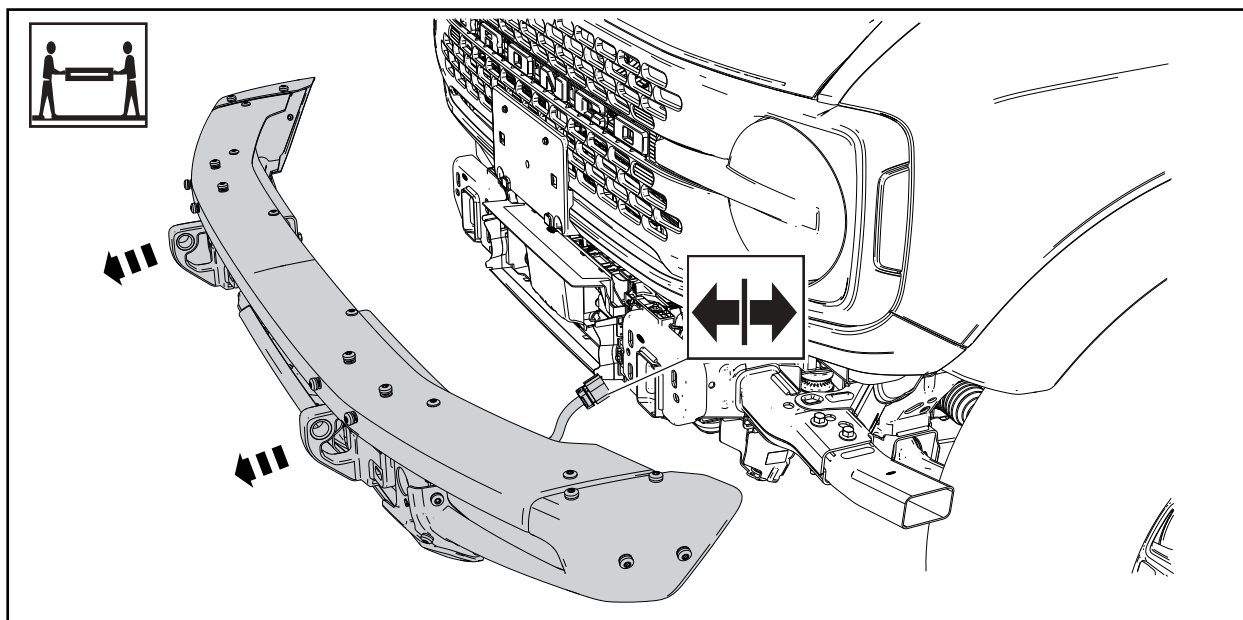

NO PART OF THIS DOCUMENT MAY BE REPRODUCED WITHOUT PRIOR AGREEMENT AND WRITTEN PERMISSION OF  
FORD PERFORMANCE PARTS

6. Remove the retainers and the front license plate mounting bracket.

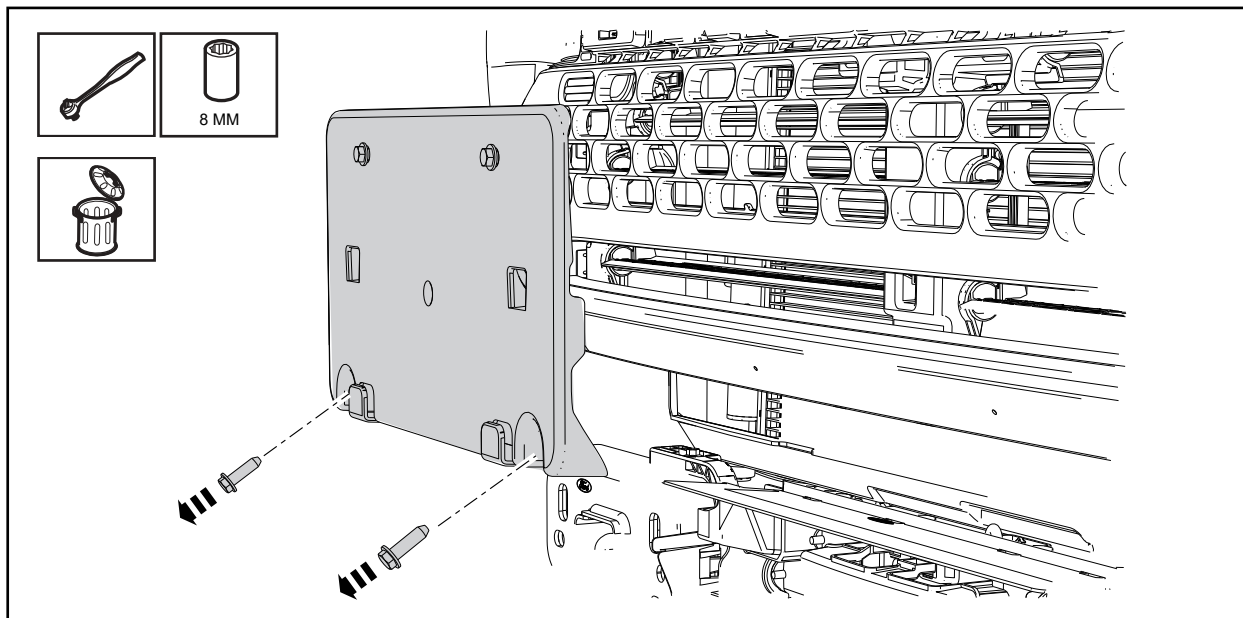

7. Remove the recovery hook holding bolts.

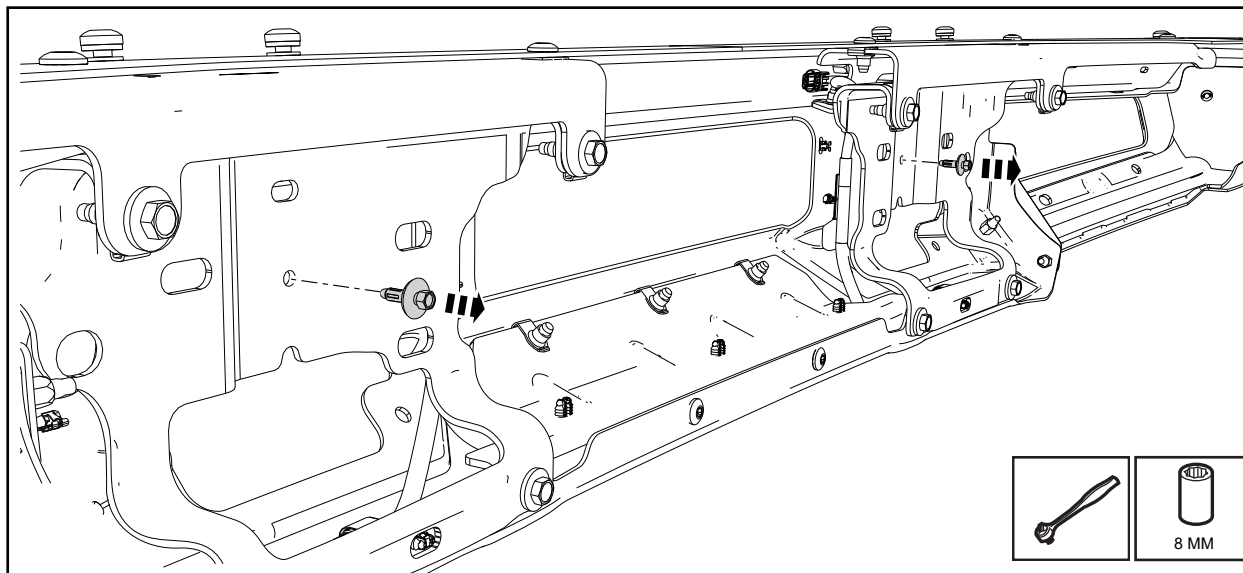

NO PART OF THIS DOCUMENT MAY BE REPRODUCED WITHOUT PRIOR AGREEMENT AND WRITTEN PERMISSION OF  
FORD PERFORMANCE PARTS

8. Remove and discard the recovery hooks.

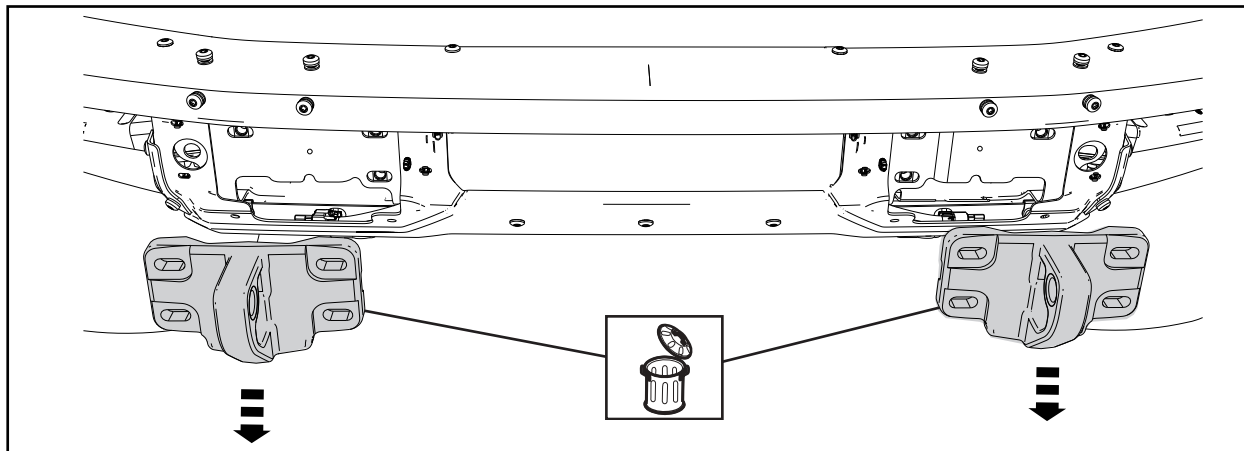

9. Remove and discard the plastic holding nuts on both sides of the vehicle.

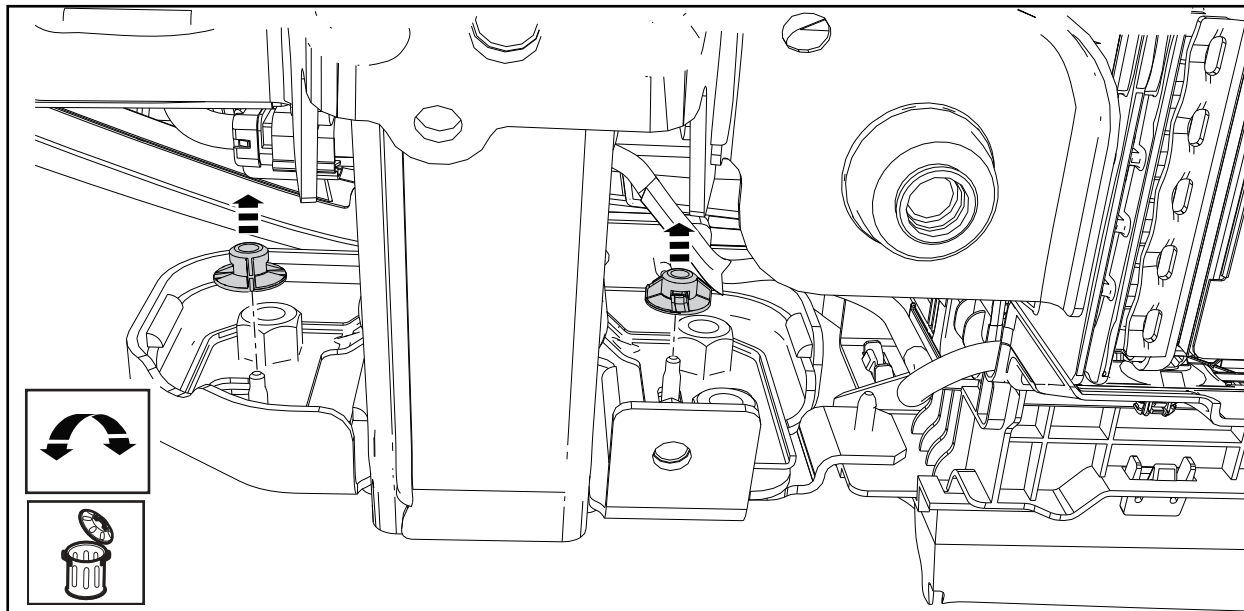

NO PART OF THIS DOCUMENT MAY BE REPRODUCED WITHOUT PRIOR AGREEMENT AND WRITTEN PERMISSION OF FORD PERFORMANCE PARTS

10. Install the two clevis brackets to the bumper.

- Torque: 10.5 Nm (7.5 ft-lb)

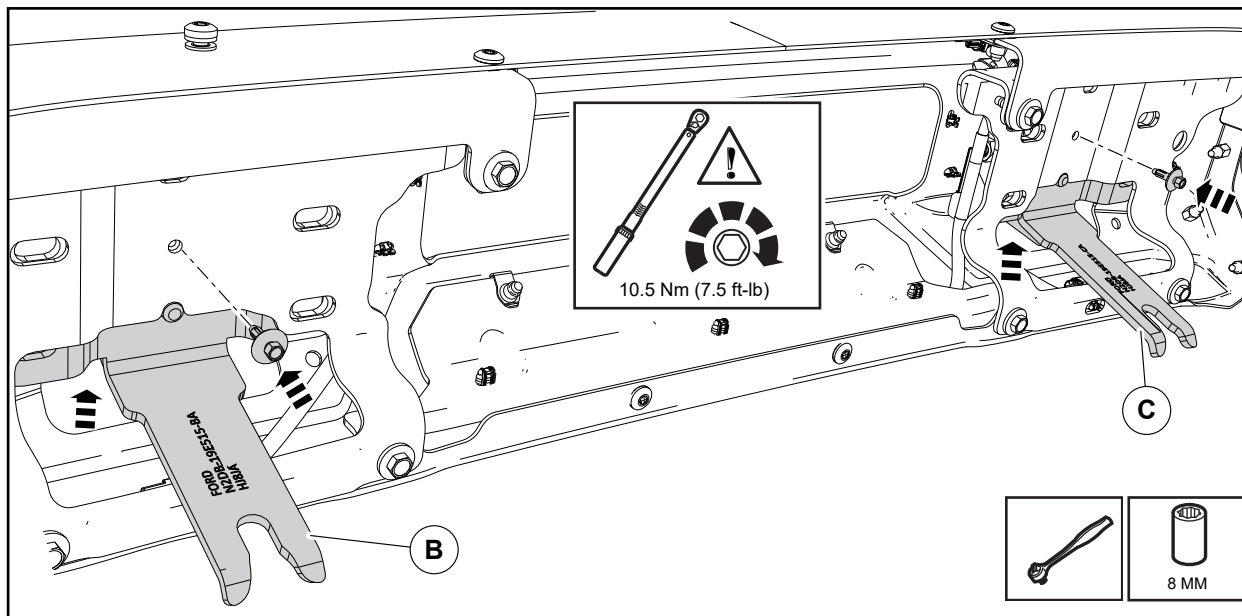

11. Remove and discard the two frame bolts. Perform this step on both sides.

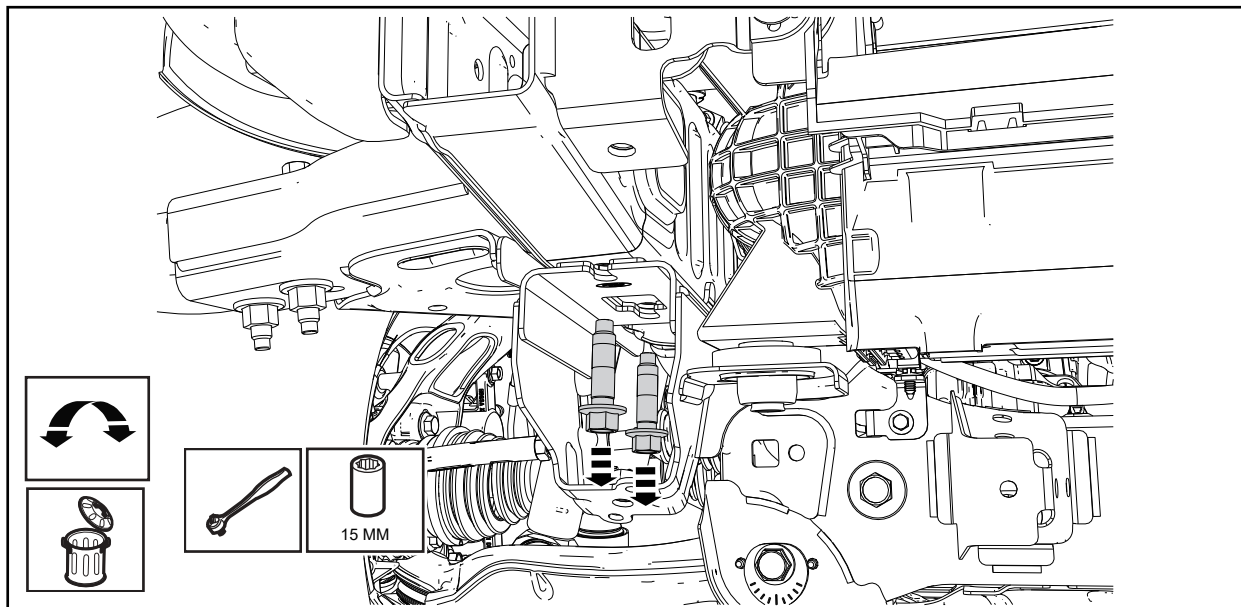

NO PART OF THIS DOCUMENT MAY BE REPRODUCED WITHOUT PRIOR AGREEMENT AND WRITTEN PERMISSION OF  
FORD PERFORMANCE PARTS

12. Install the winch CAC bracket and bolts to the frame.

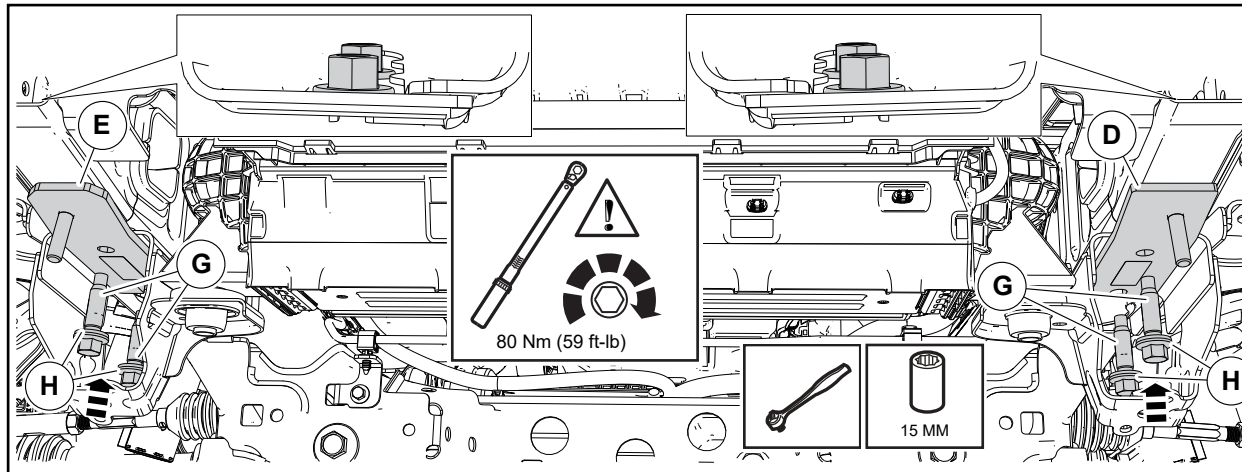

13. Install the shoulder bolt into the frame rail. Perform this step on both sides of the vehicle.

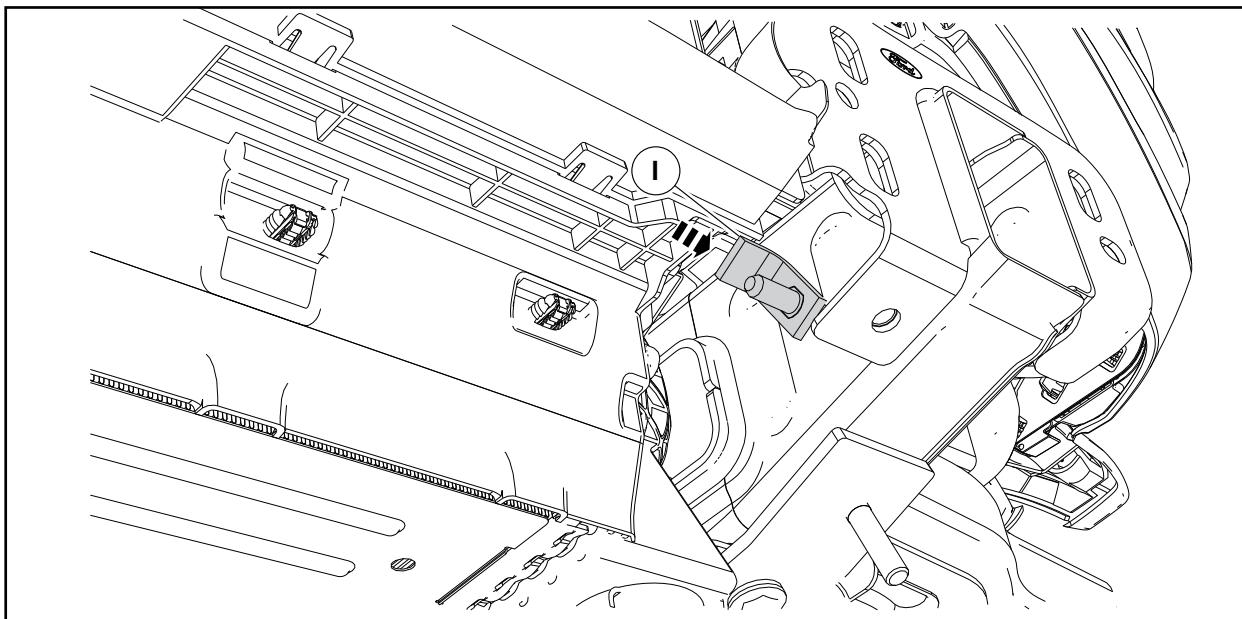

NO PART OF THIS DOCUMENT MAY BE REPRODUCED WITHOUT PRIOR AGREEMENT AND WRITTEN PERMISSION OF FORD PERFORMANCE PARTS

14. Install the tinnerman nut onto the shoulder bolt. Perform this step on both sides of the vehicle.

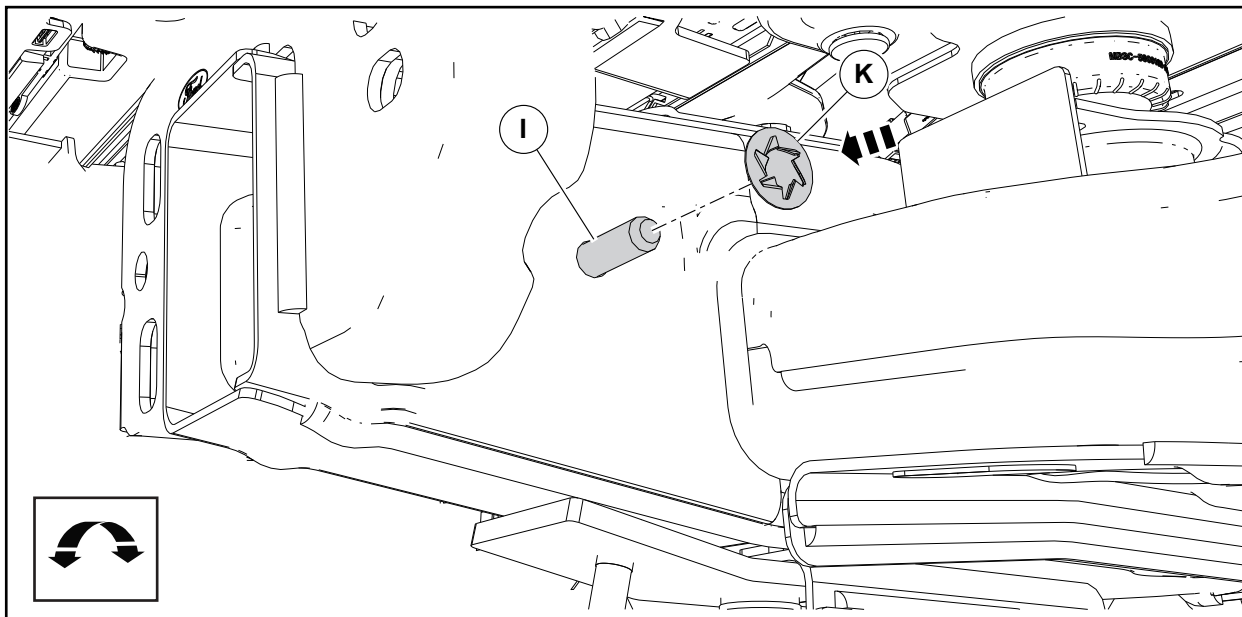

15. Install the left hand inner and outer bracket to the frame rail. Hand tighten the nuts at this time.

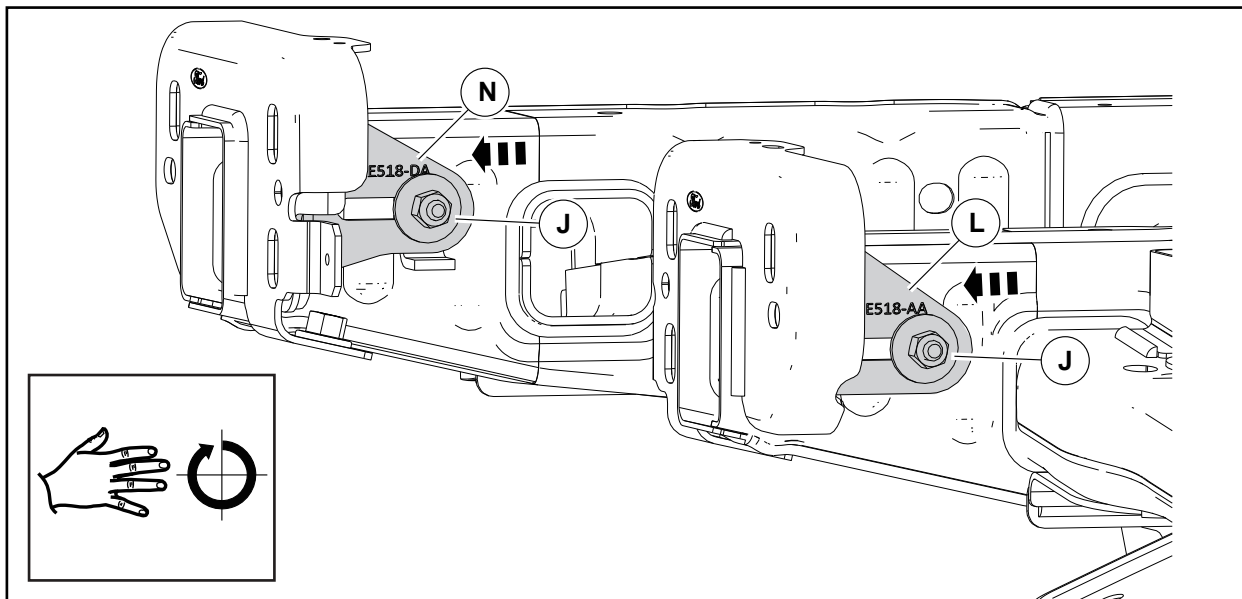

NO PART OF THIS DOCUMENT MAY BE REPRODUCED WITHOUT PRIOR AGREEMENT AND WRITTEN PERMISSION OF  
FORD PERFORMANCE PARTS

16. Install the right hand inner and outer bracket to the frame rail. Hand tighten the nuts at this time.

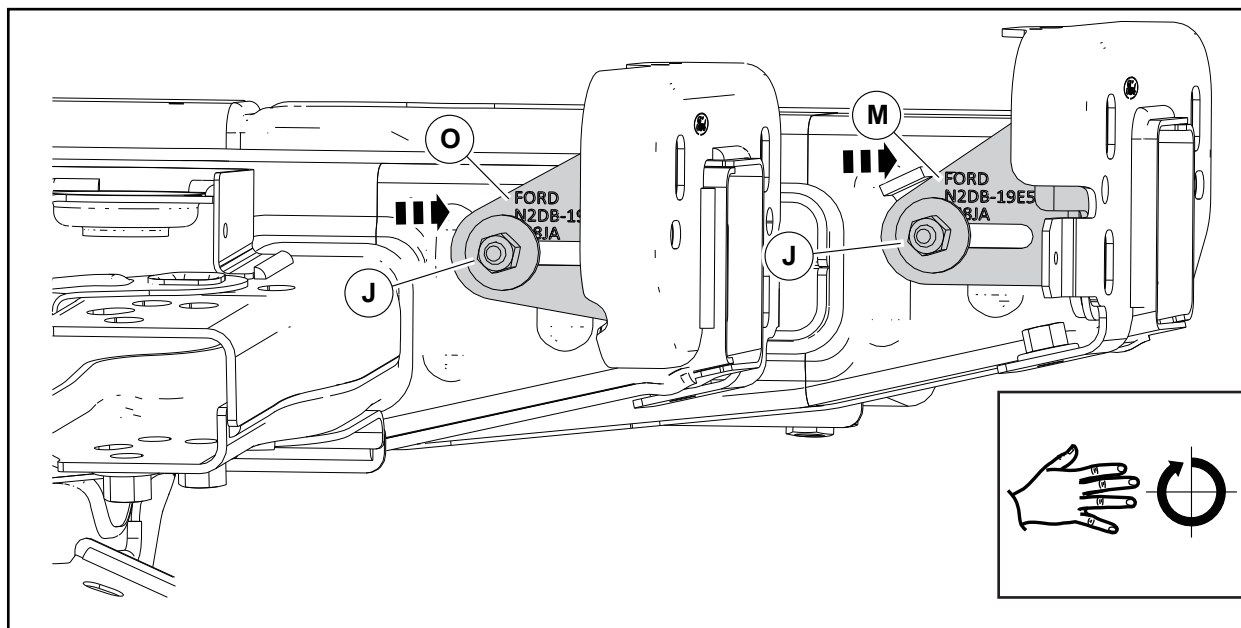

17. Install the frame rail bracket.

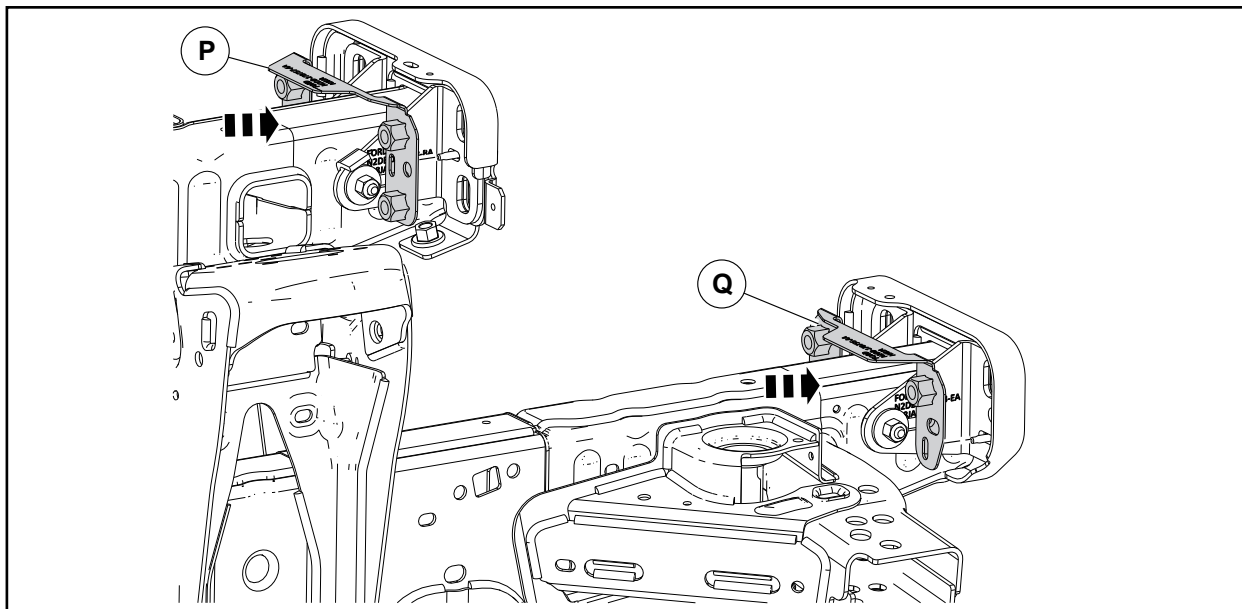

NO PART OF THIS DOCUMENT MAY BE REPRODUCED WITHOUT PRIOR AGREEMENT AND WRITTEN PERMISSION OF  
FORD PERFORMANCE PARTS

18. Starting by hand, install the plastic holding nuts. Perform this step on both sides.

- Torque: 10 Nm (7 ft-lb)

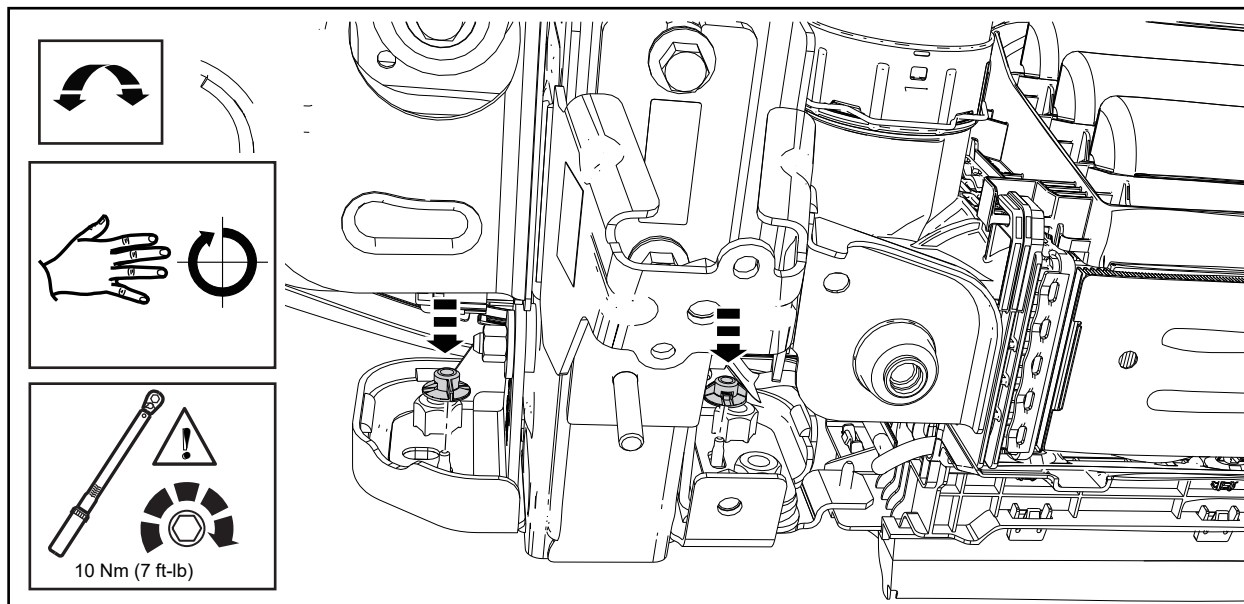

19. Tighten the left hand inner and outer brackets.

- Torque: 48 Nm (35.5 ft-lb)

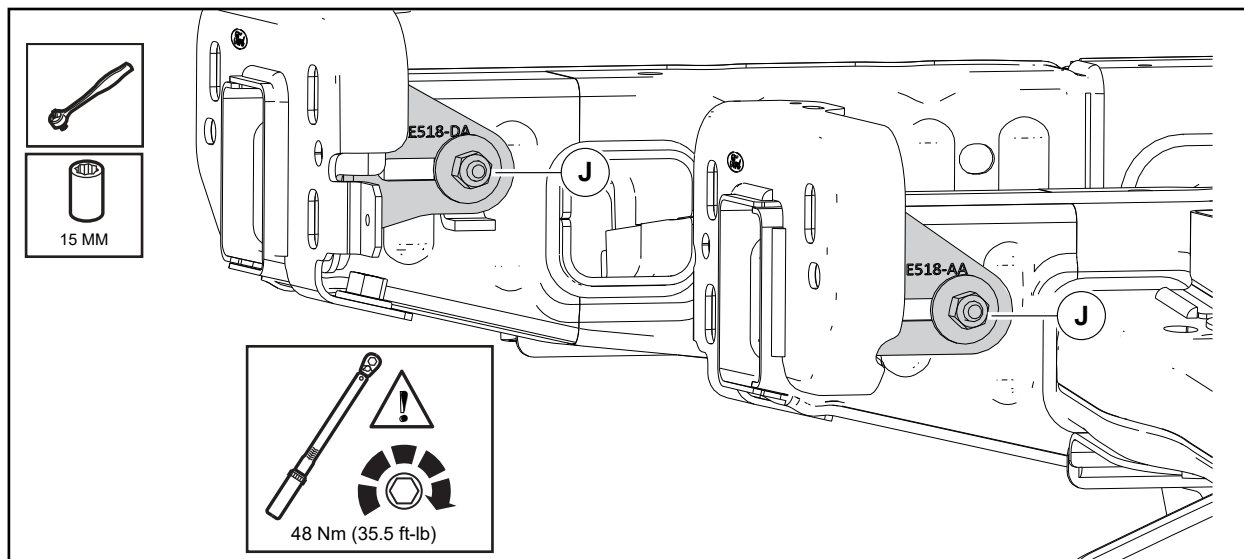

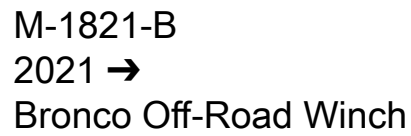

20. Tighten the right hand inner and outer brackets.

- Torque: 48 Nm (35.5 ft-lb)

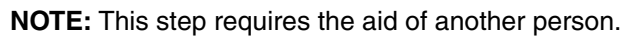

21. Install the front bumper and connect the electrical connector.

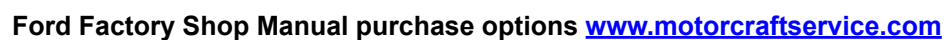

NO PART OF THIS DOCUMENT MAY BE REPRODUCED WITHOUT PRIOR AGREEMENT AND WRITTEN PERMISSION OF  
FORD PERFORMANCE PARTS

**NOTE:** This step requires the aid of another person.

22. Install the front bumper retainers.

- Torque: 80 Nm (59 ft-lb)

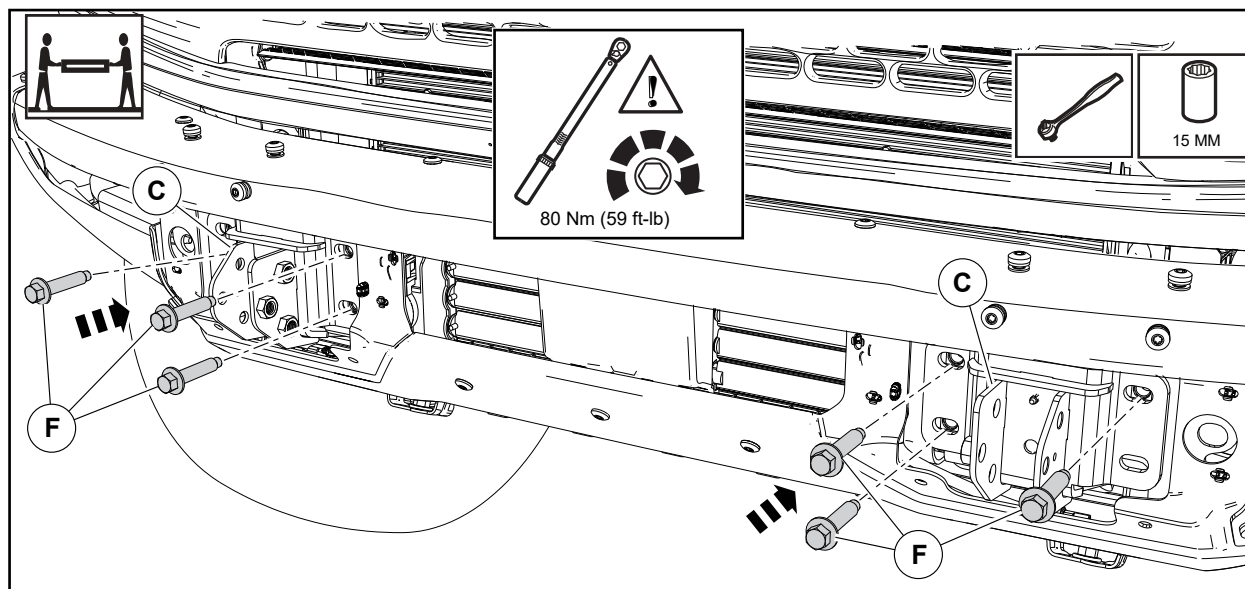

23. Install the clevis bracket nuts.

- Torque: 35 Nm (25.8 ft-lb)

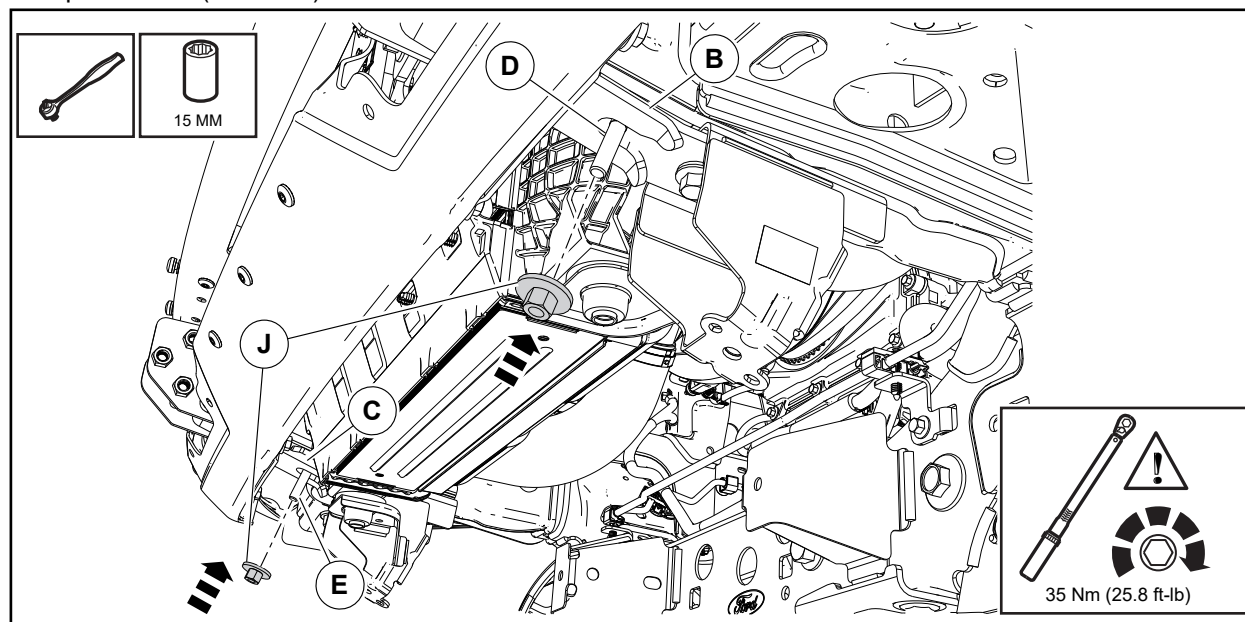

NO PART OF THIS DOCUMENT MAY BE REPRODUCED WITHOUT PRIOR AGREEMENT AND WRITTEN PERMISSION OF  
FORD PERFORMANCE PARTS

24. Install the recover forging into the clevis bracket.

- Torque: 110 Nm (81 ft-lb)

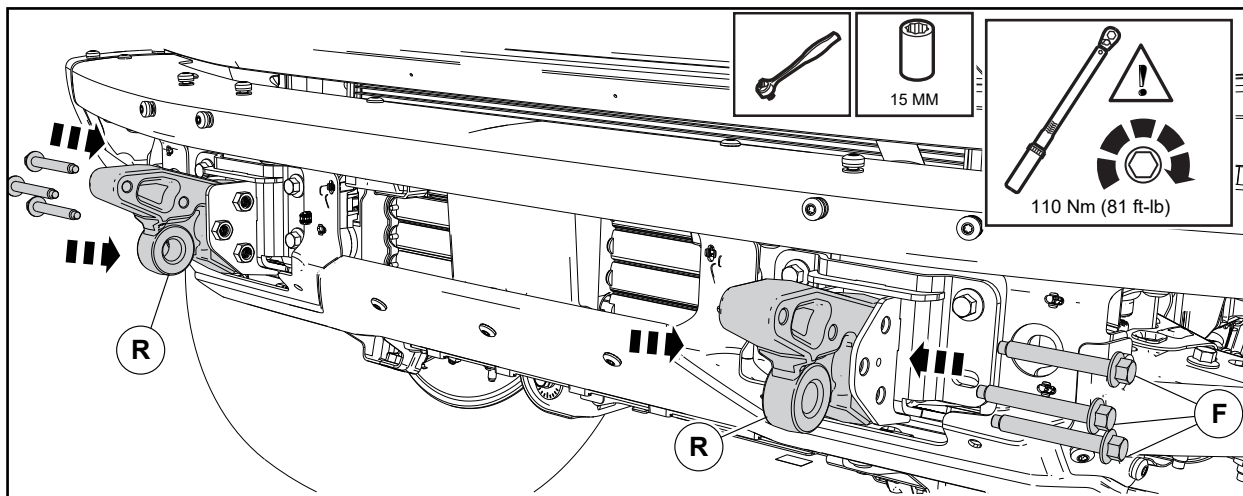

25. Install the front bumper trim panels.

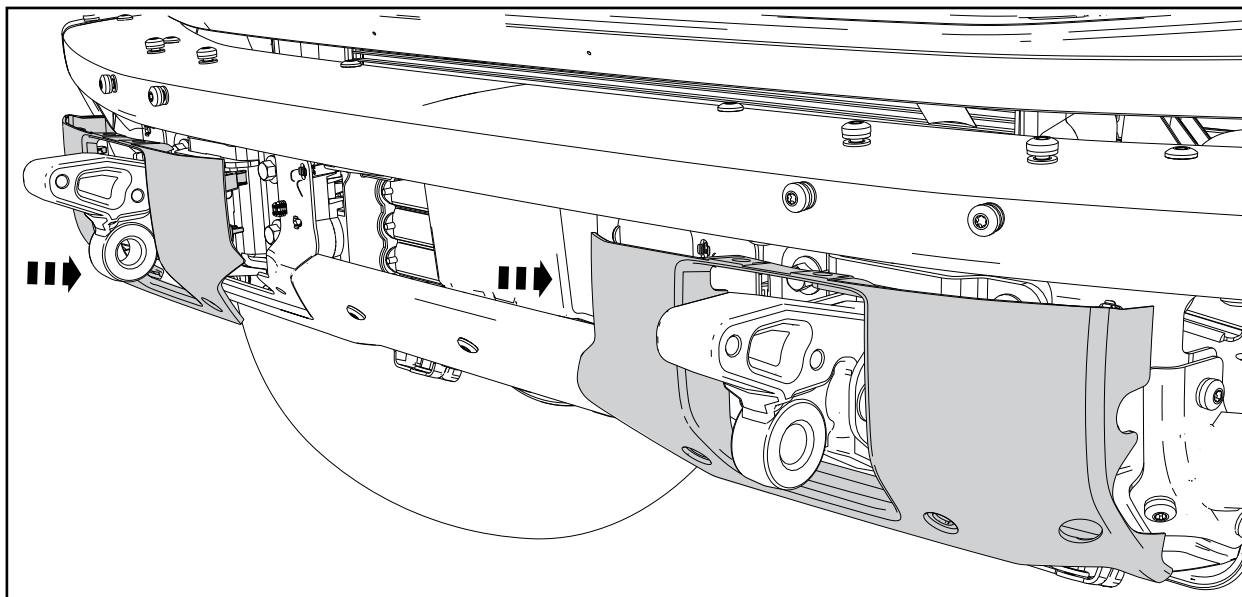

NO PART OF THIS DOCUMENT MAY BE REPRODUCED WITHOUT PRIOR AGREEMENT AND WRITTEN PERMISSION OF  
FORD PERFORMANCE PARTS

26. Install the front bumper trim panel push pins.

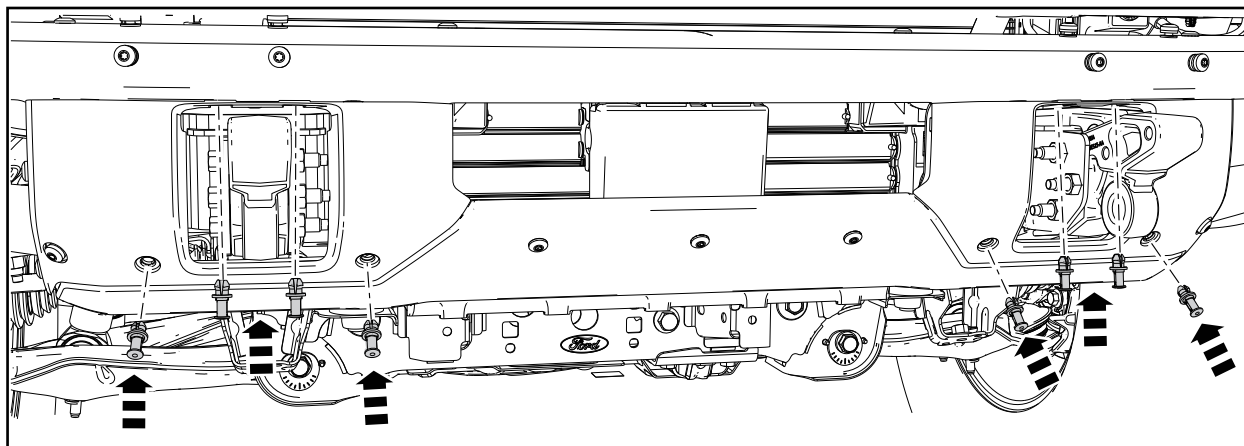

27. Install the recovery forging mounting bracket.

• Torque: 80 Nm (59 ft-lb)

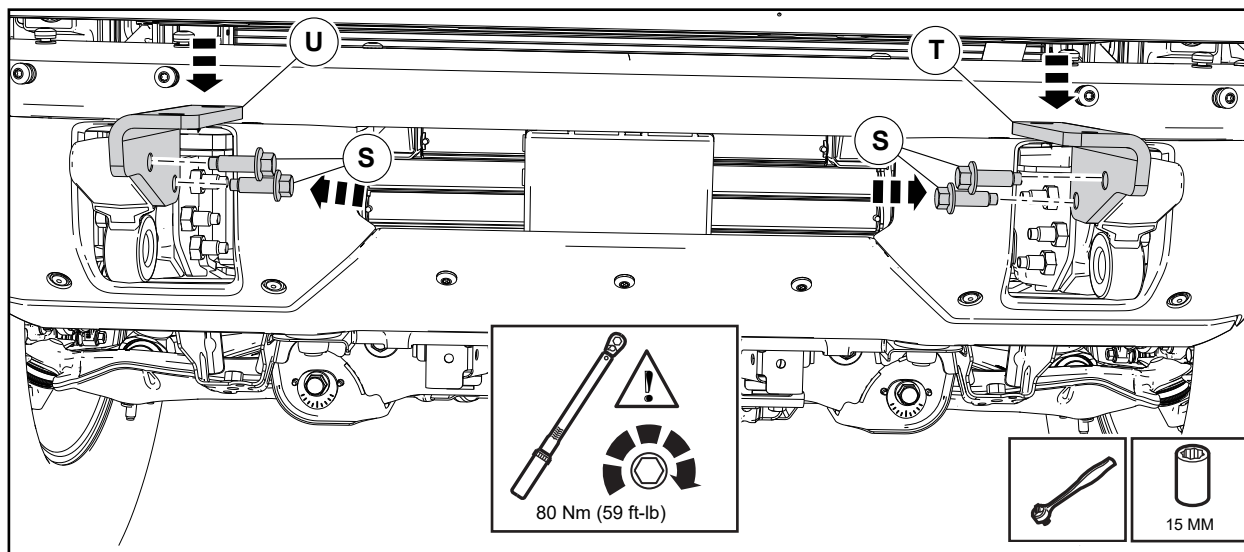

NO PART OF THIS DOCUMENT MAY BE REPRODUCED WITHOUT PRIOR AGREEMENT AND WRITTEN PERMISSION OF FORD PERFORMANCE PARTS

**NOTE:** Installation of license plate bracket is optional depending on local regulations.

28. Install the fairlead to the winch plate.

- Torque: 47.5 Nm (35 ft-lb)

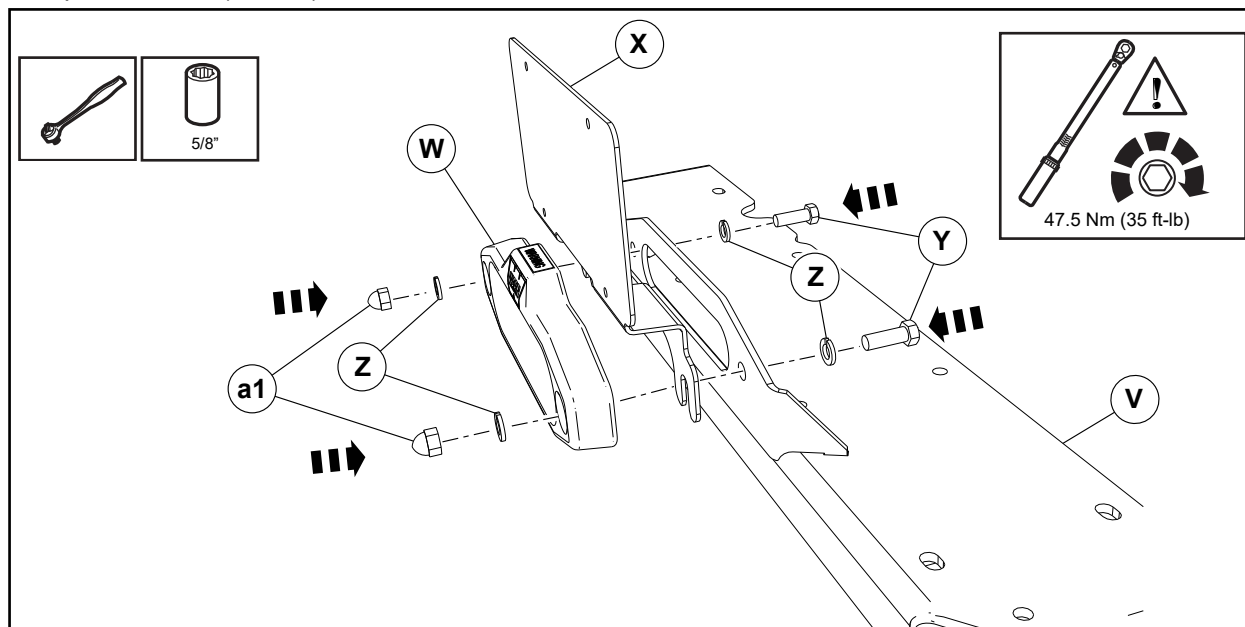

29. If equipped, install the license plate to license plate mounting bracket retainers.

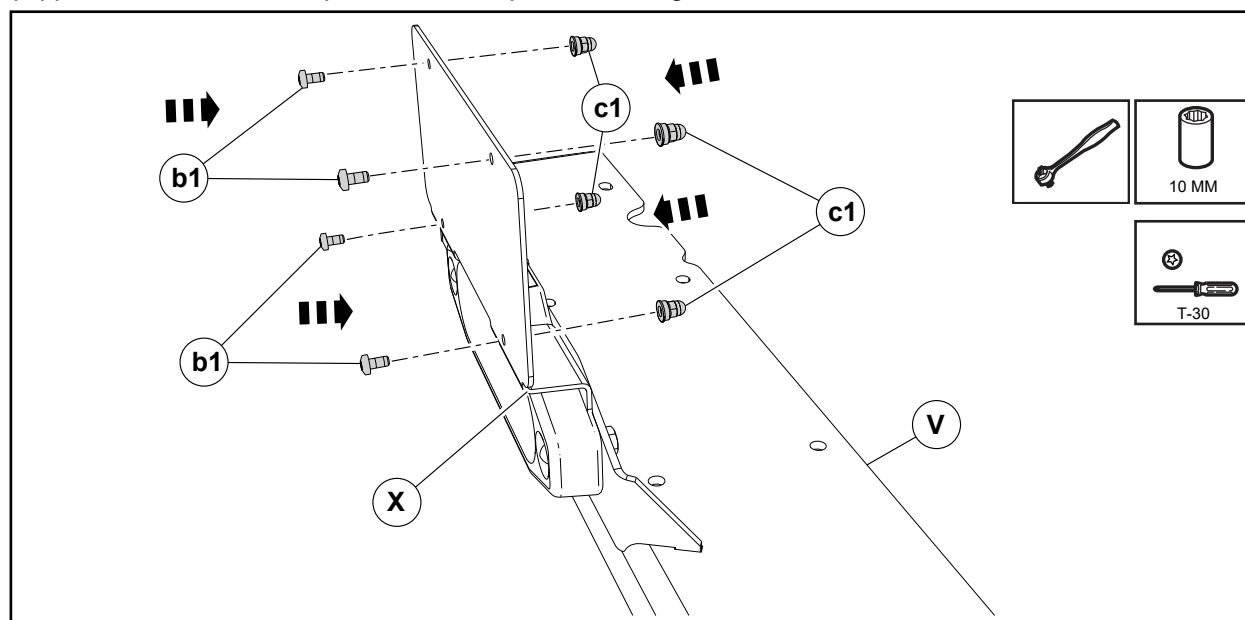

NO PART OF THIS DOCUMENT MAY BE REPRODUCED WITHOUT PRIOR AGREEMENT AND WRITTEN PERMISSION OF  
FORD PERFORMANCE PARTS

30. Install the winch mounting nuts into the winch housing slots.

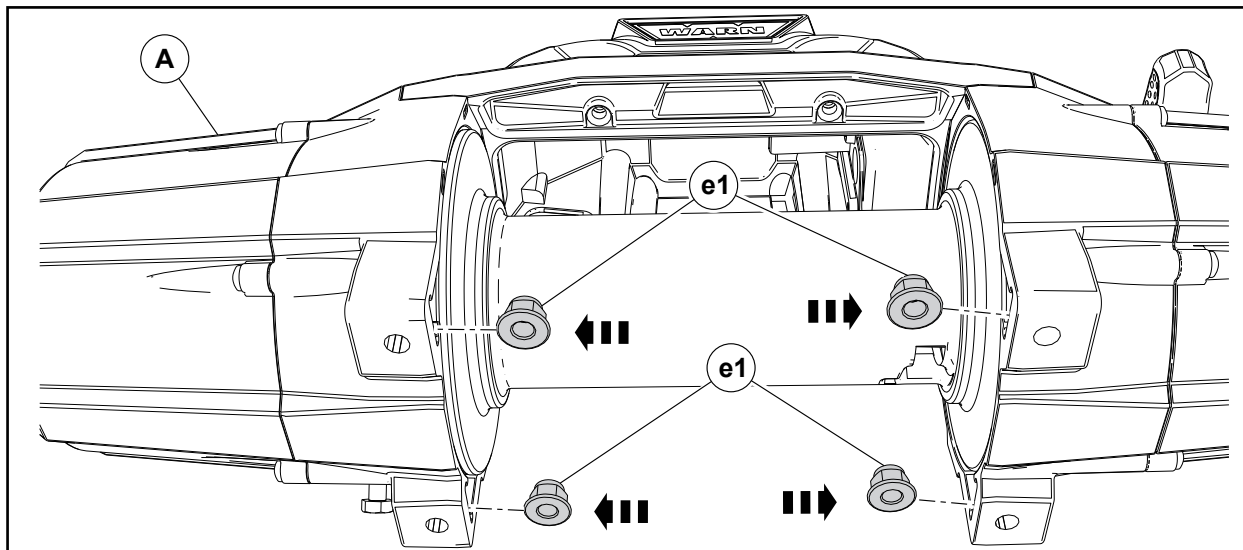

31. Route the winch rope through the fairlead and install the winch to the winch plate.

• Torque: 47.5 Nm (35 ft-lb)

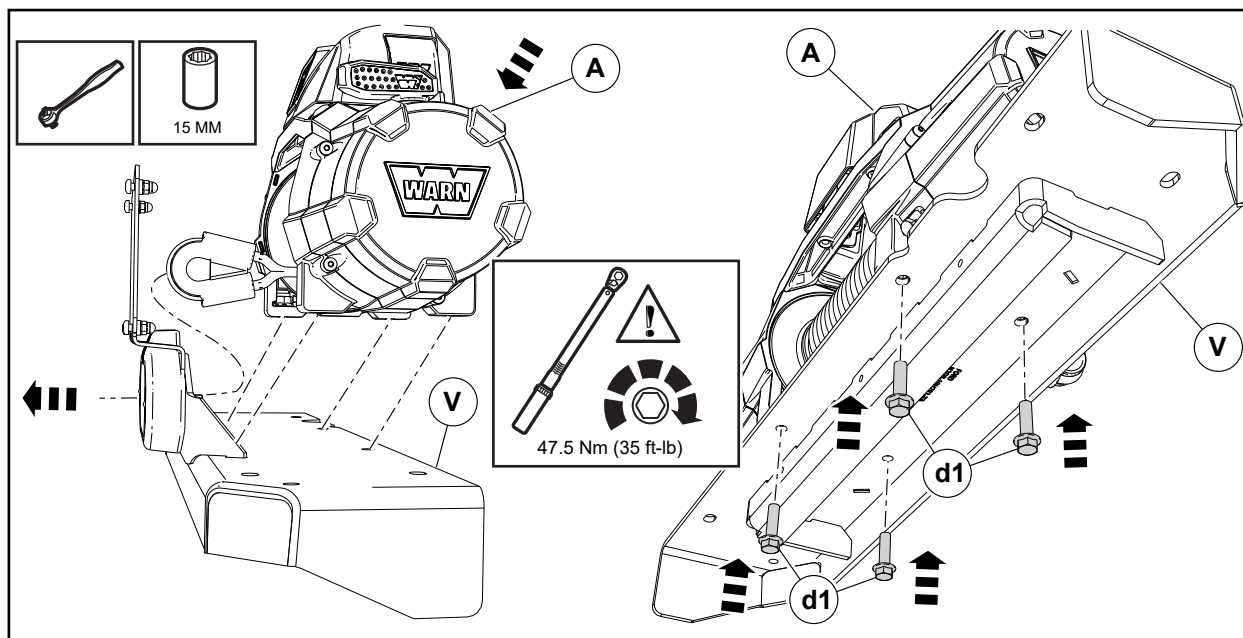

NO PART OF THIS DOCUMENT MAY BE REPRODUCED WITHOUT PRIOR AGREEMENT AND WRITTEN PERMISSION OF  
FORD PERFORMANCE PARTS

32. Engage the winch wire harness push pin retainers into the winch plate.

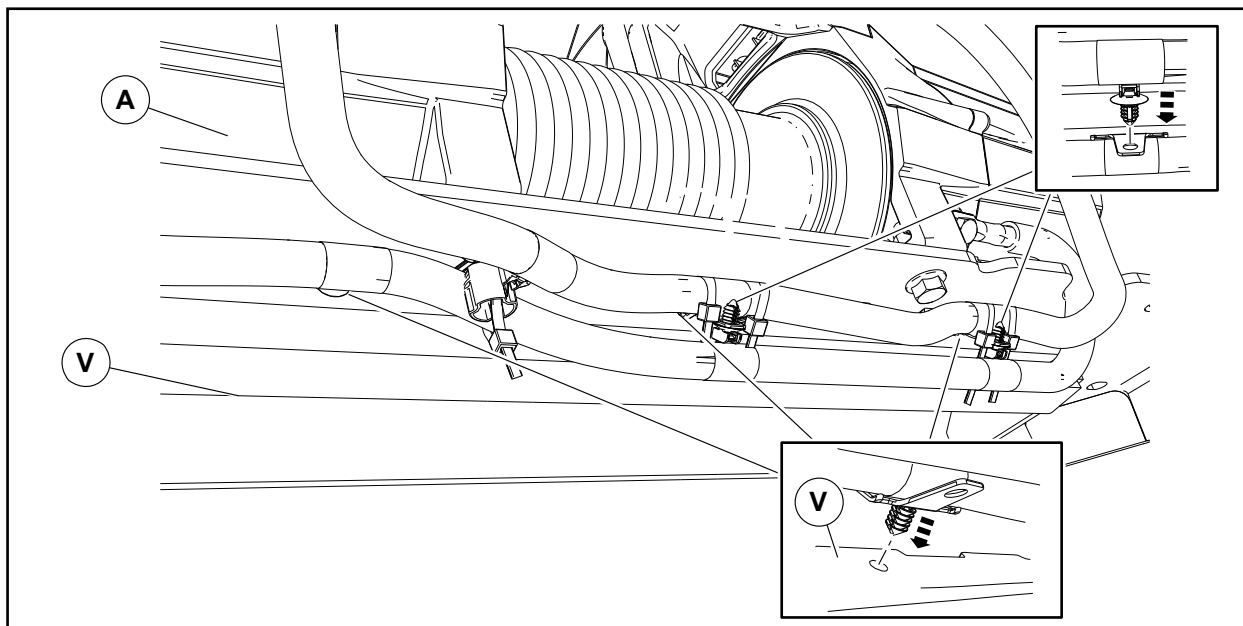

33. Install the brush bar to the winch plate.

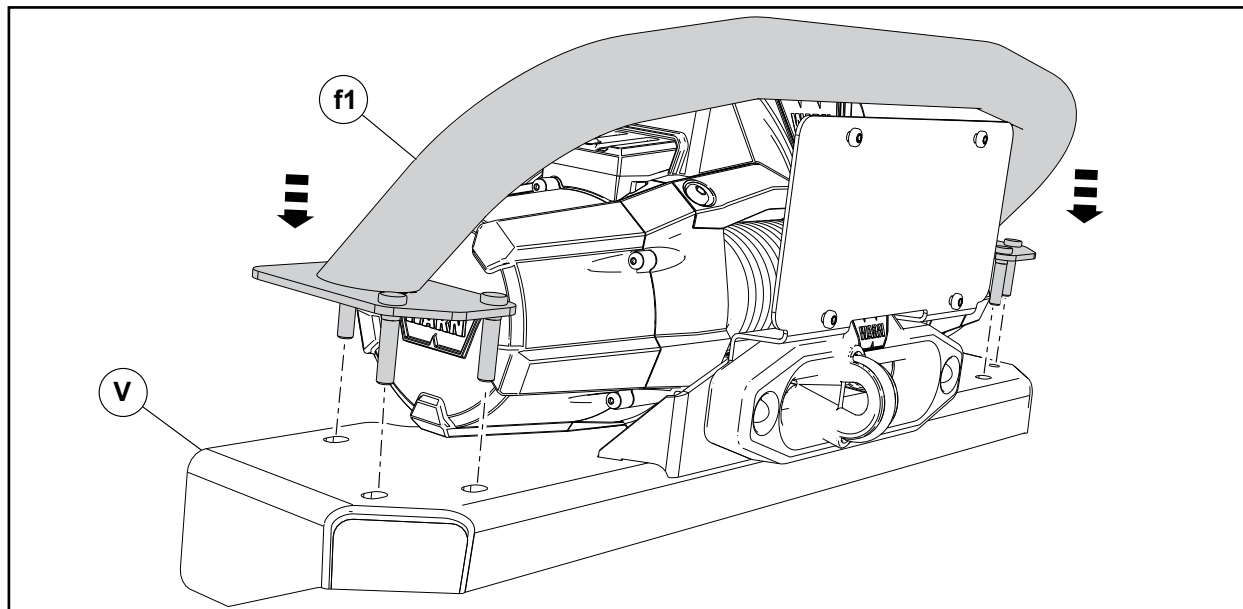

NO PART OF THIS DOCUMENT MAY BE REPRODUCED WITHOUT PRIOR AGREEMENT AND WRITTEN PERMISSION OF  
FORD PERFORMANCE PARTS

34. Install the brush bar outboard nut.

- Torque: 47.5 Nm (35 ft-lb)

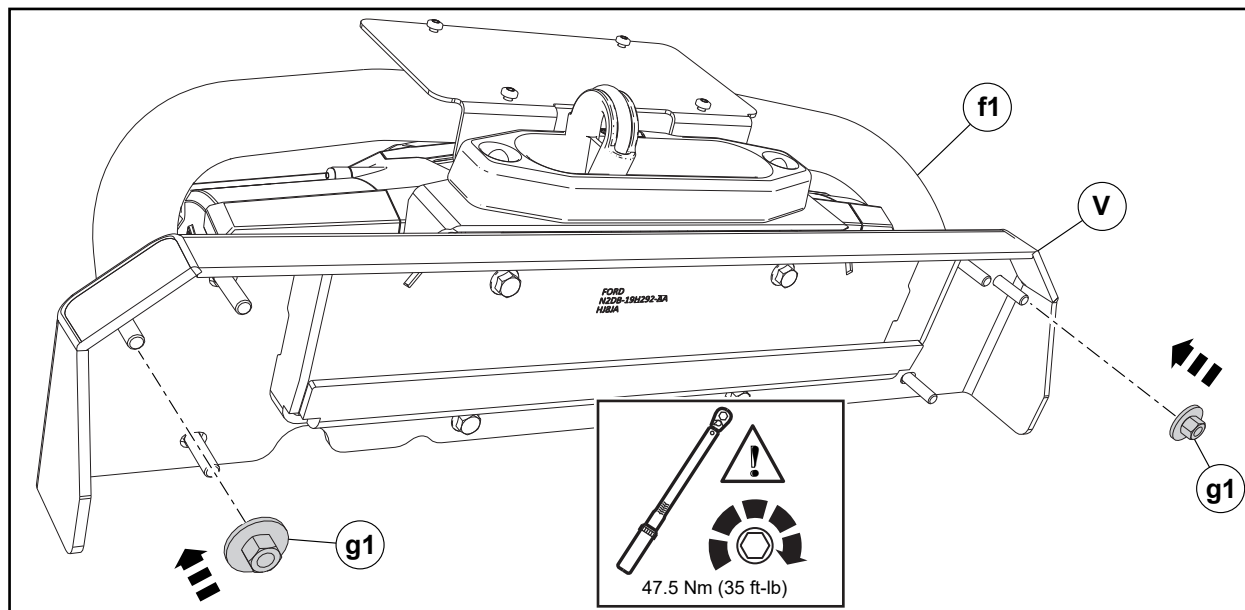

NO PART OF THIS DOCUMENT MAY BE REPRODUCED WITHOUT PRIOR AGREEMENT AND WRITTEN PERMISSION OF  
FORD PERFORMANCE PARTS

35. Install the winch assembly to the recovery forging mounting brackets.

- Torque: 47.5 Nm (35 ft-lb)

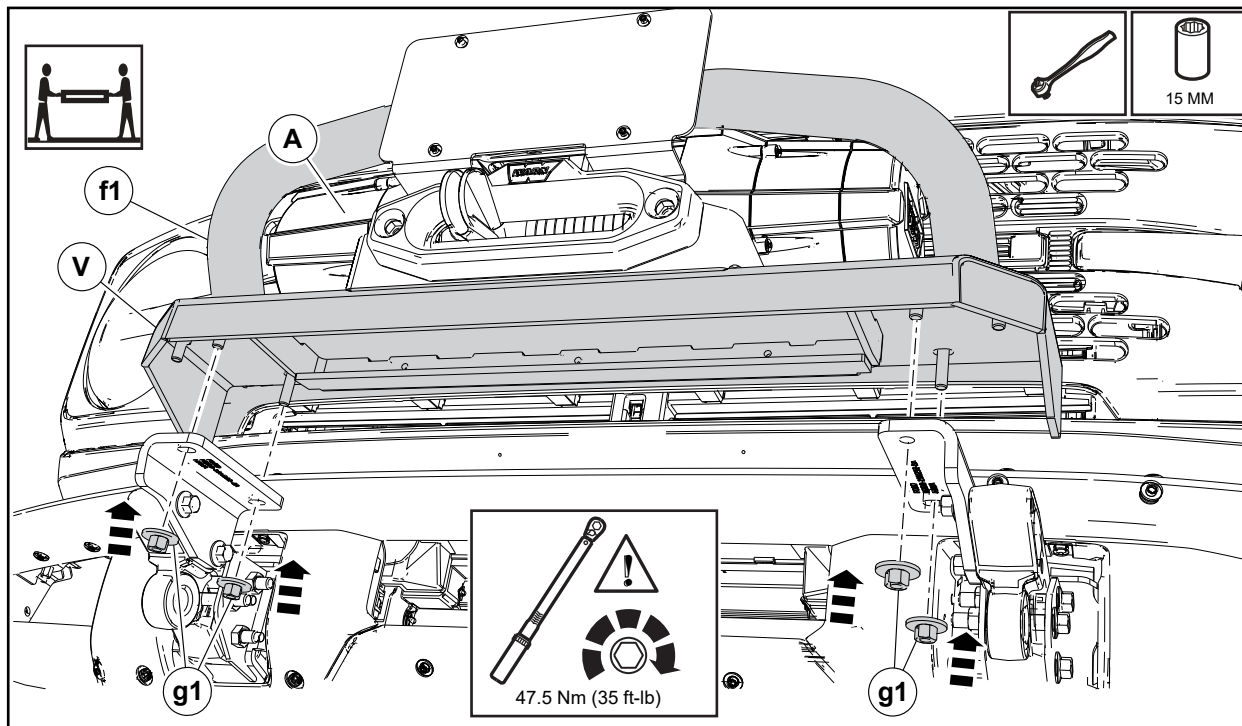

36. Remove the lug nuts and the left hand tire.

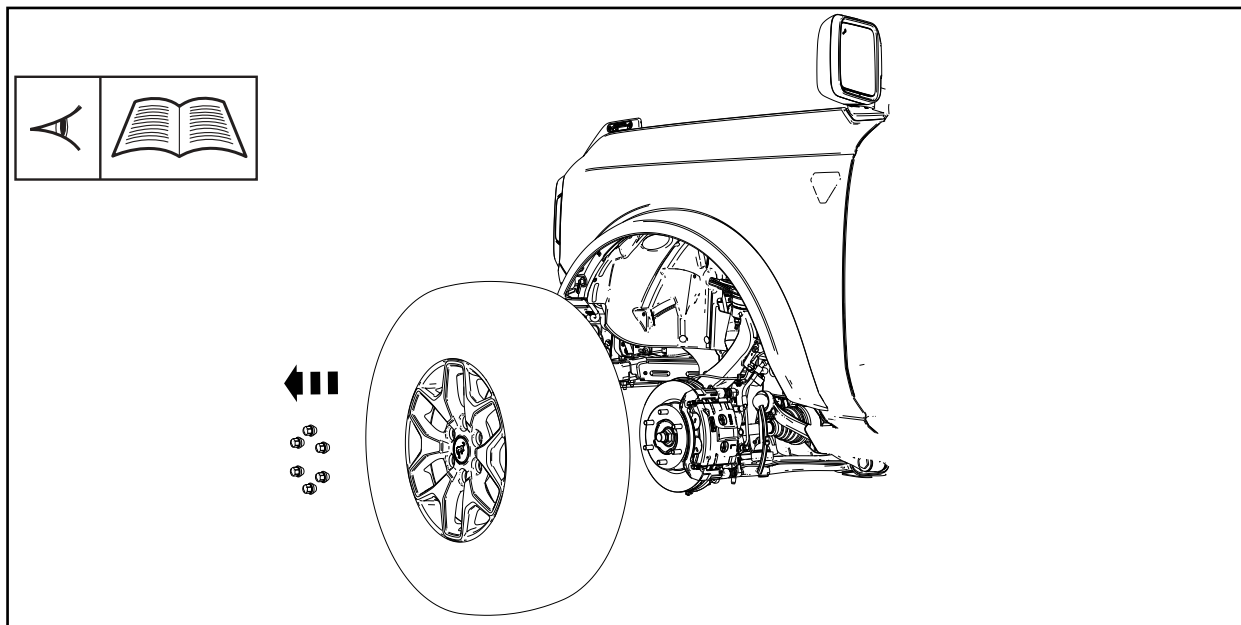

NO PART OF THIS DOCUMENT MAY BE REPRODUCED WITHOUT PRIOR AGREEMENT AND WRITTEN PERMISSION OF  
FORD PERFORMANCE PARTS

37. Remove the retainers and the left hand wheel well splash shield.

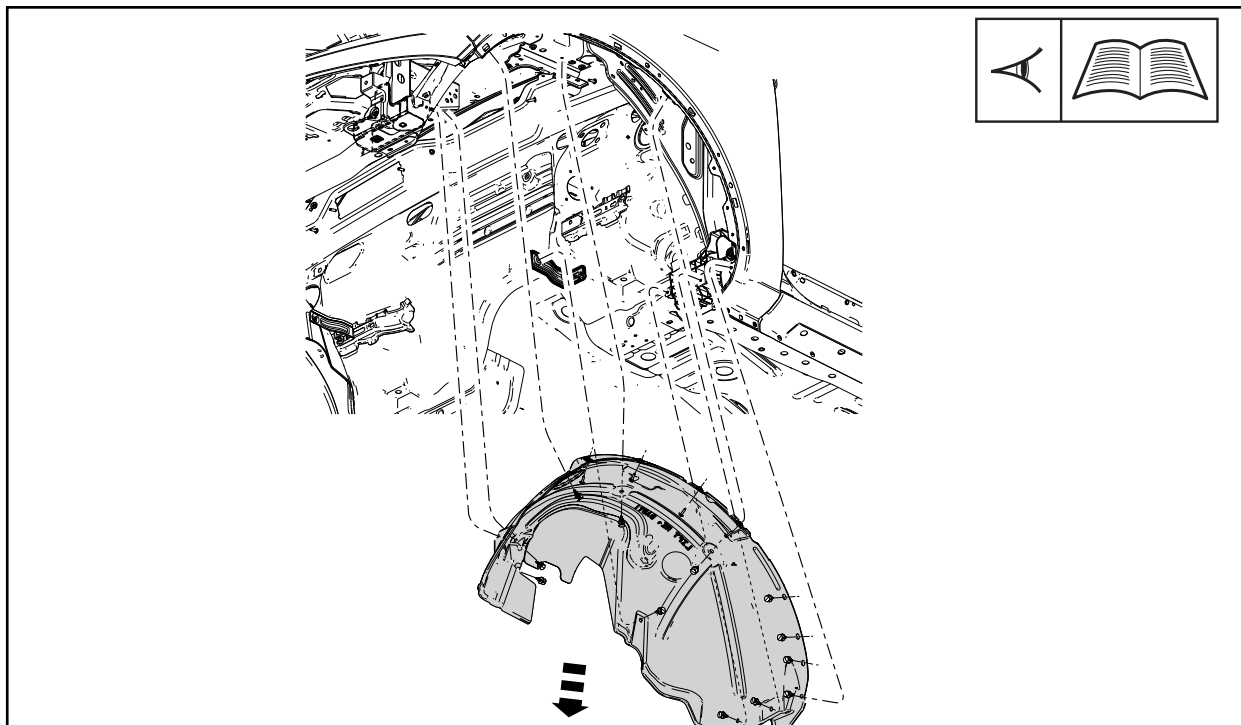

38. Route the positive battery cable under the winch plate and through the left hand side of the center bumper opening. Route the negative cable over top of the left hand recovery forging.

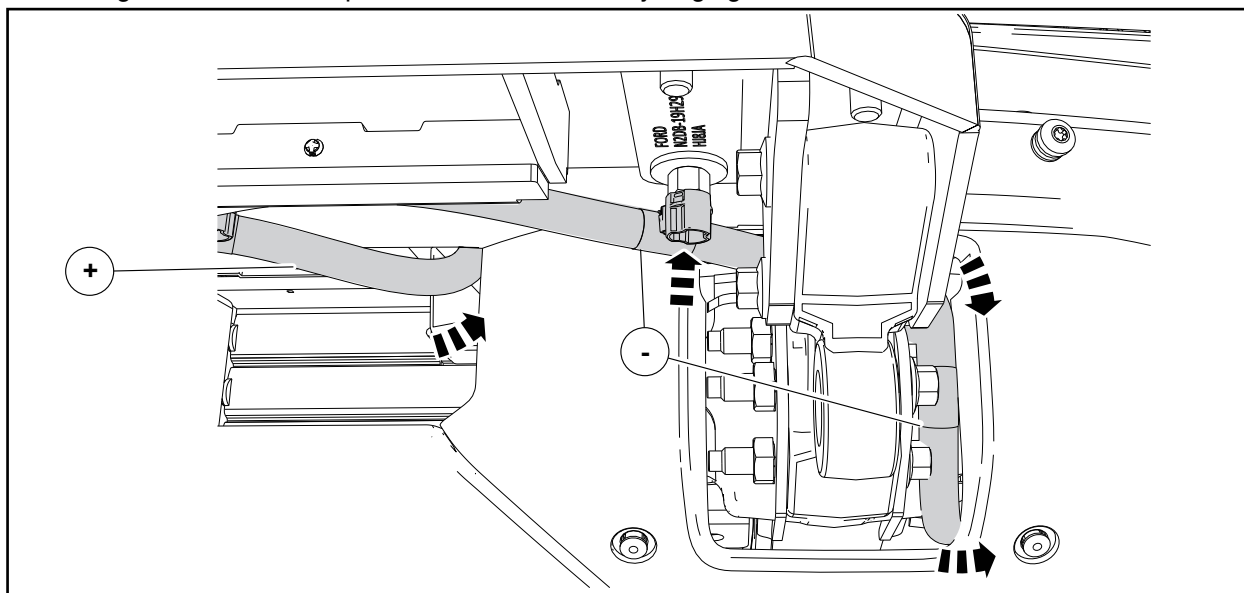

NO PART OF THIS DOCUMENT MAY BE REPRODUCED WITHOUT PRIOR AGREEMENT AND WRITTEN PERMISSION OF  
FORD PERFORMANCE PARTS

39. Route the positive cable through the frame towards the left hand side of the vehicle.

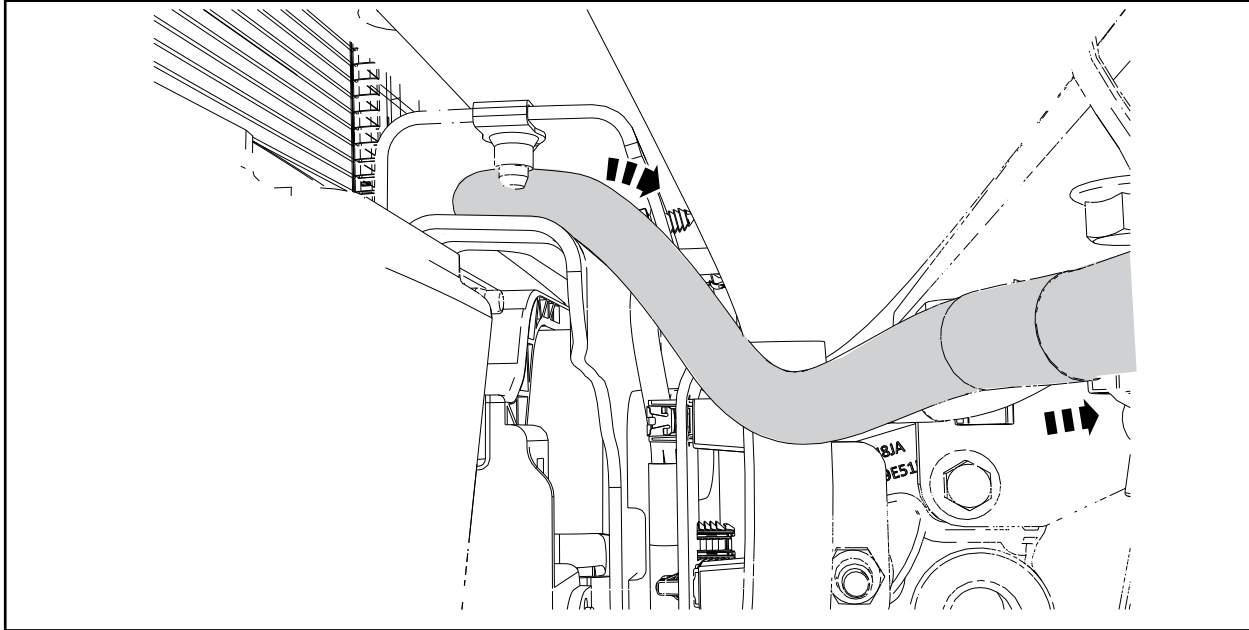

NO PART OF THIS DOCUMENT MAY BE REPRODUCED WITHOUT PRIOR AGREEMENT AND WRITTEN PERMISSION OF  
FORD PERFORMANCE PARTS

40. Route the positive and negative cables upwards towards the battery. Secure the cables to the existing wiring harness using tie straps.

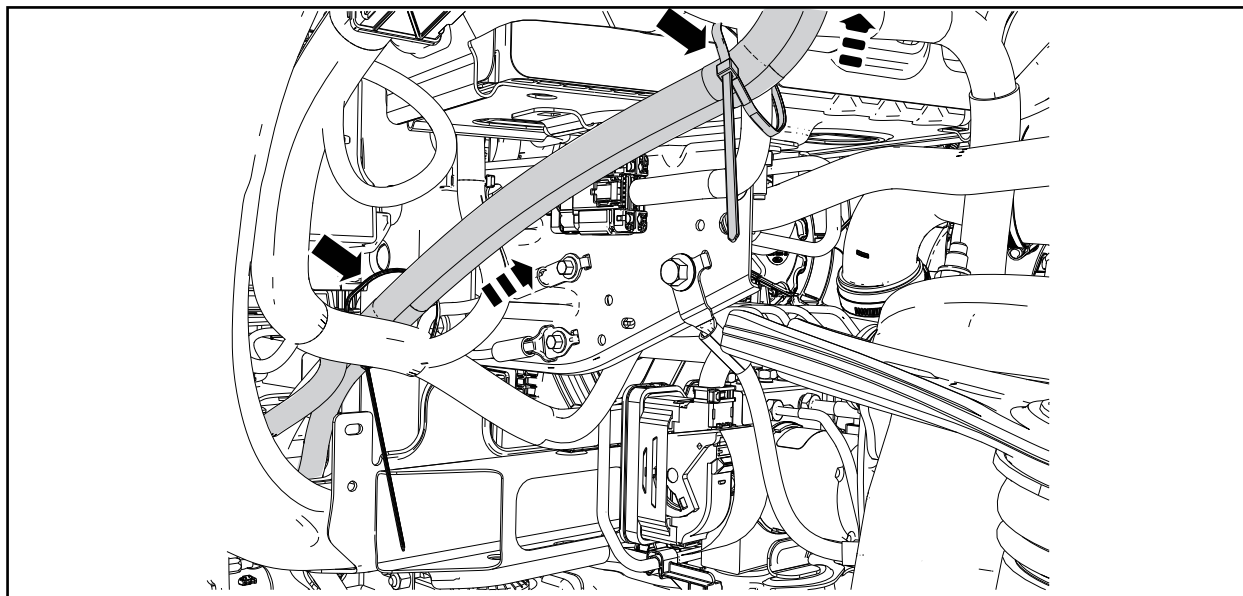
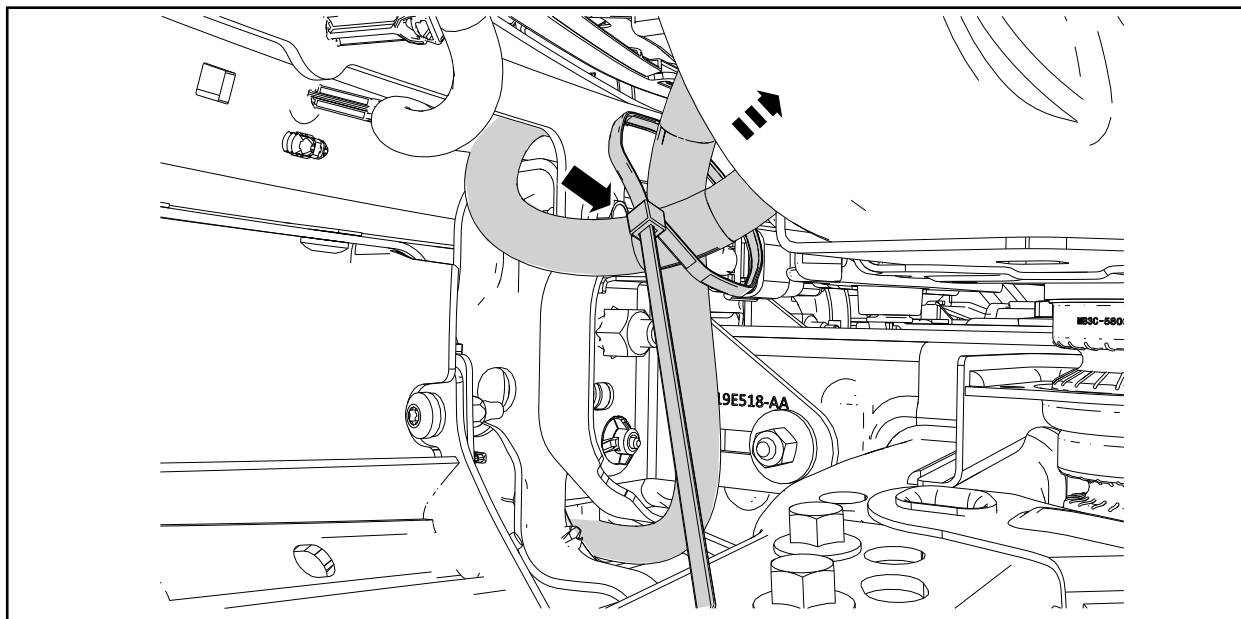

NO PART OF THIS DOCUMENT MAY BE REPRODUCED WITHOUT PRIOR AGREEMENT AND WRITTEN PERMISSION OF  
FORD PERFORMANCE PARTS

41. Open the hood of the vehicle.

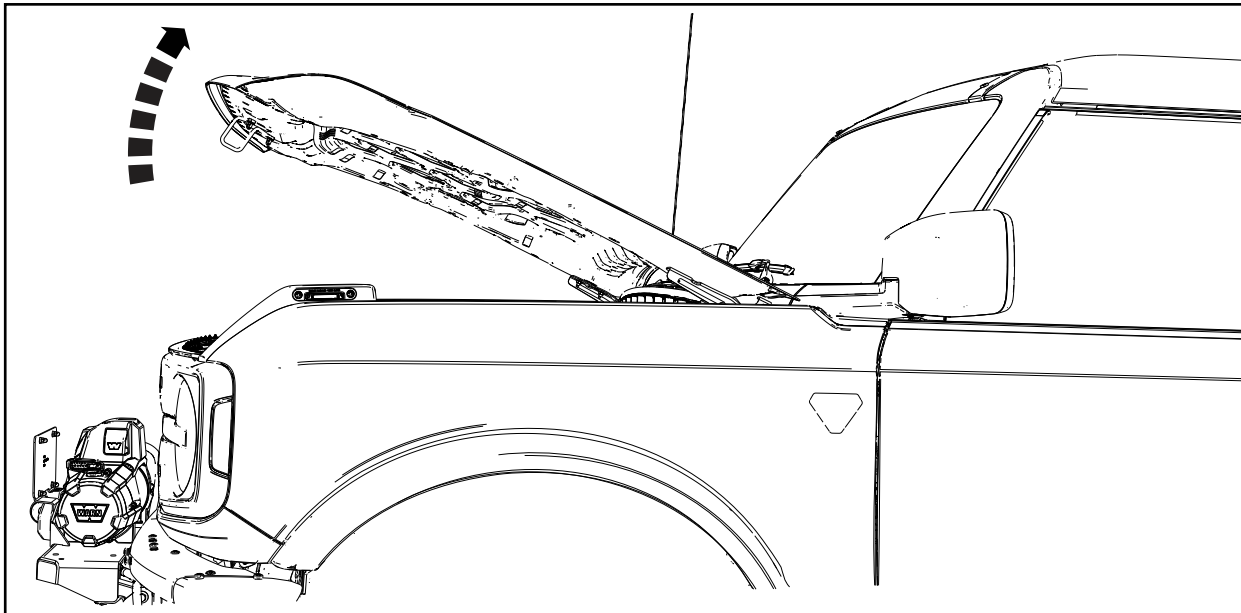

42. Position aside the positive battery terminal cover.

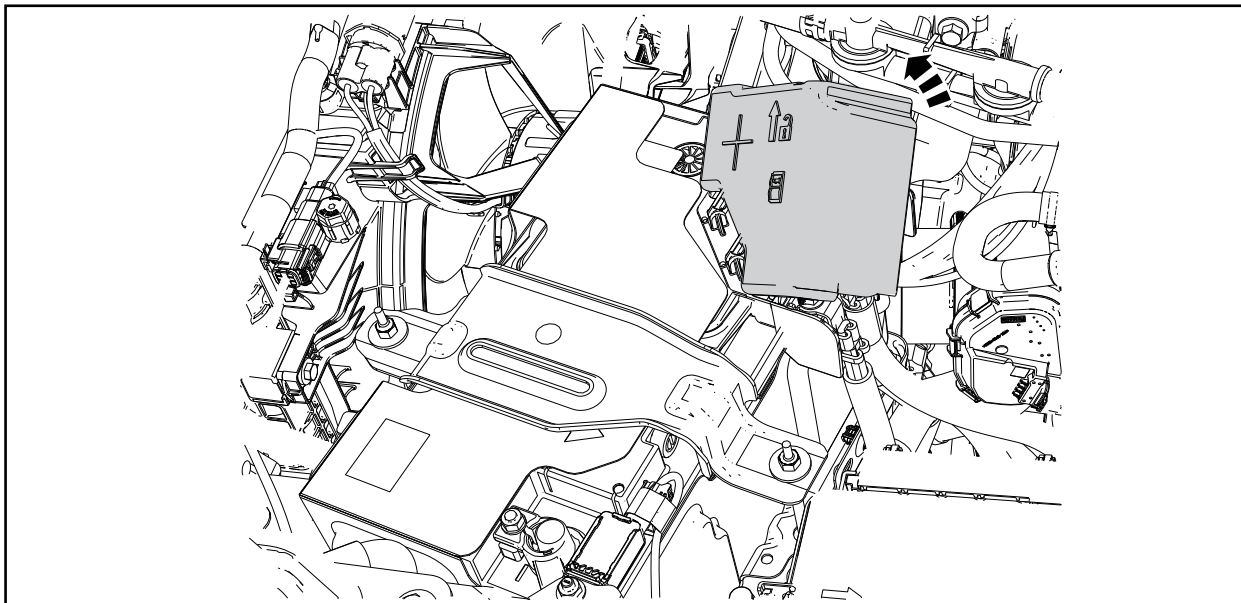

NO PART OF THIS DOCUMENT MAY BE REPRODUCED WITHOUT PRIOR AGREEMENT AND WRITTEN PERMISSION OF  
FORD PERFORMANCE PARTS

43. Connect the positive winch cable to the positive bus bar on the vehicles battery.

- Torque: 13.5 Nm (10 ft-lb)

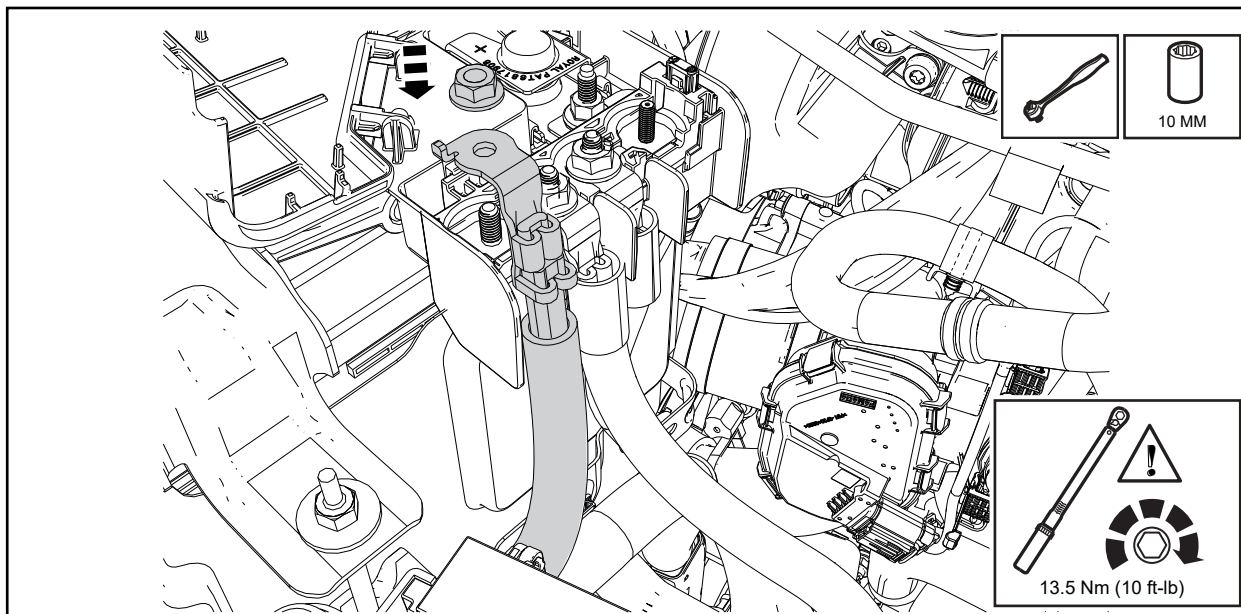

44. Position back the positive battery terminal cover.

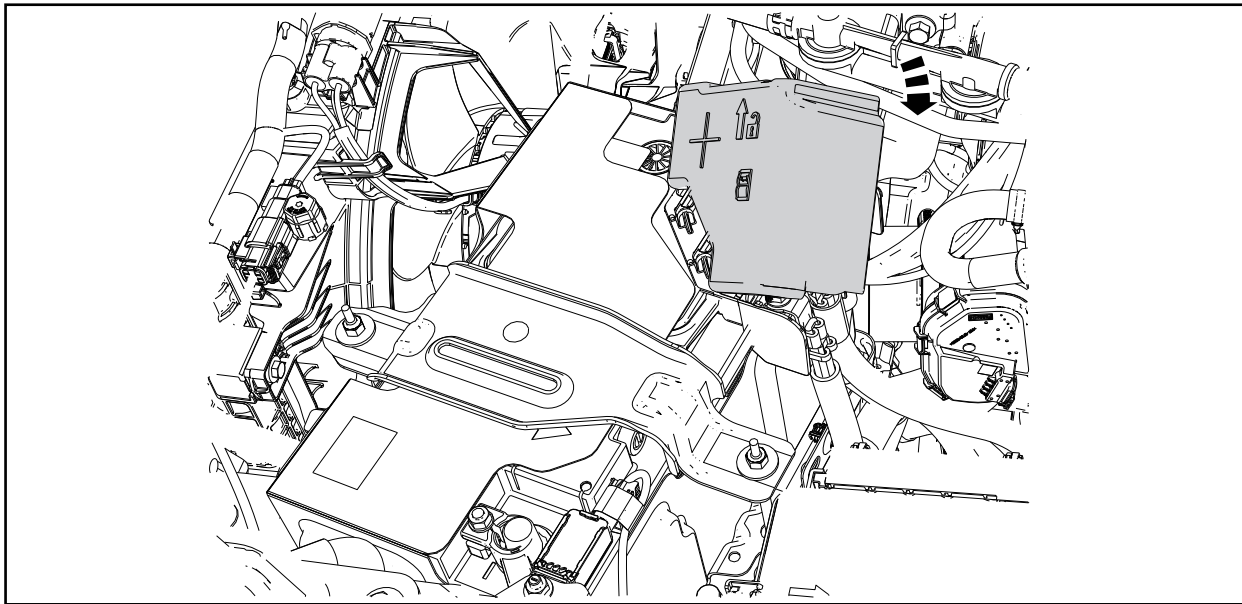

NO PART OF THIS DOCUMENT MAY BE REPRODUCED WITHOUT PRIOR AGREEMENT AND WRITTEN PERMISSION OF  
FORD PERFORMANCE PARTS

45. Connect the negative winch cable to the negative terminal on the vehicles battery.

- Torque: 13.5 Nm (10 ft-lb)

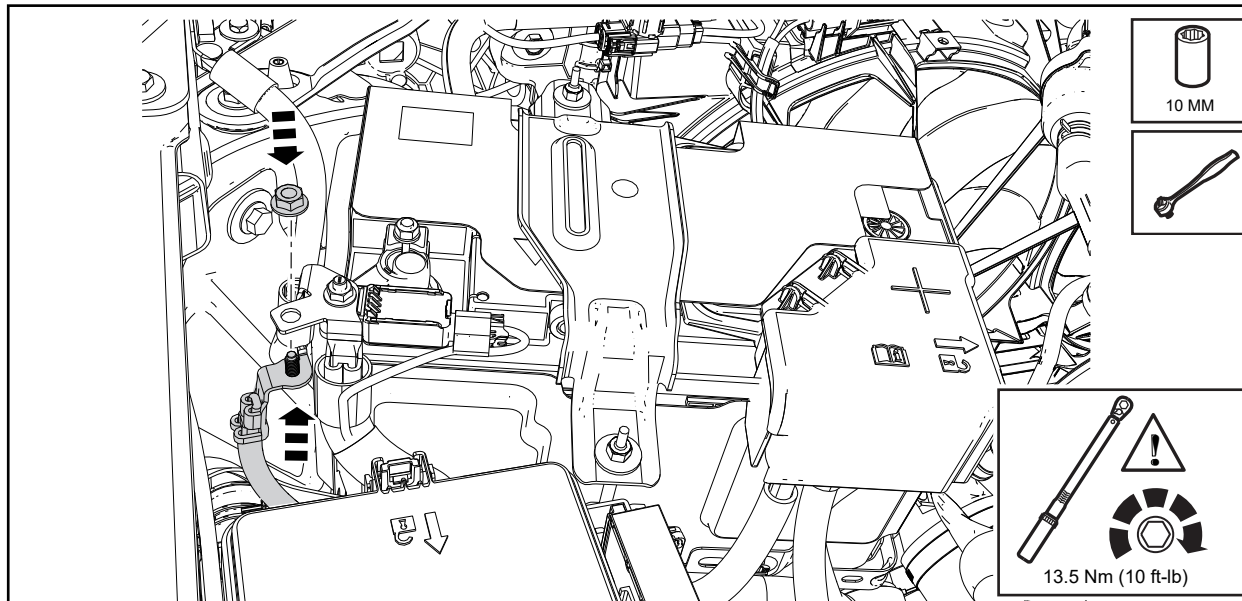

46. Install the tow hook and tow hook strap to the winch cable eyelet.

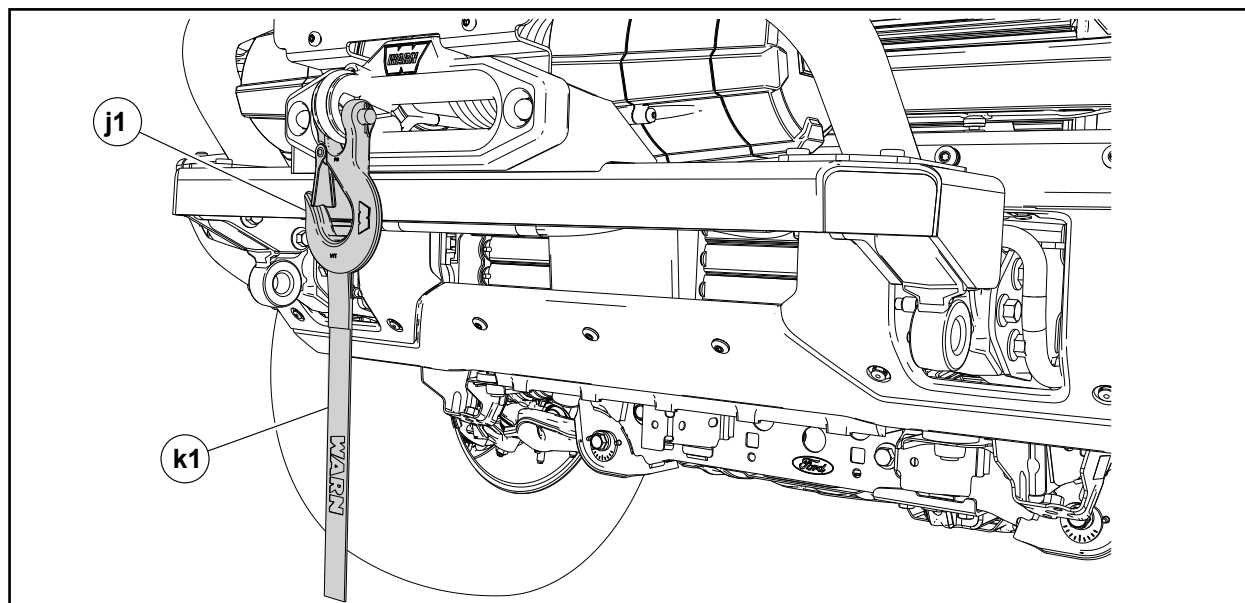

NO PART OF THIS DOCUMENT MAY BE REPRODUCED WITHOUT PRIOR AGREEMENT AND WRITTEN PERMISSION OF FORD PERFORMANCE PARTS

47. Connect the remote to the winch and test the operation. Store the winch remote in the center console.

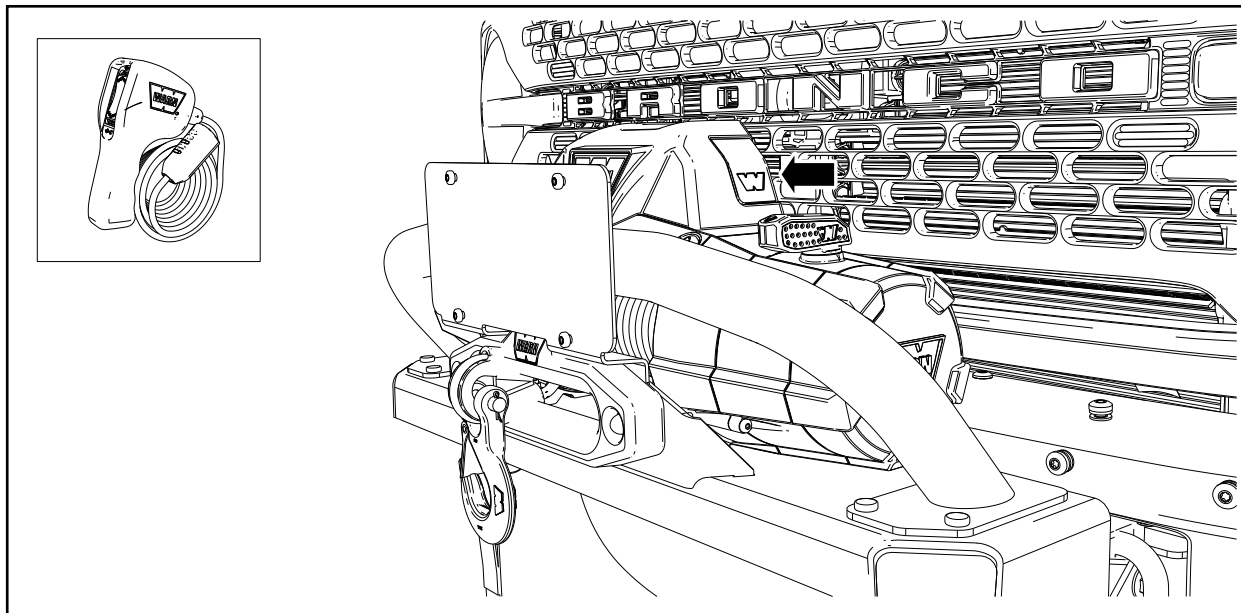

48. Close the hood of the vehicle.

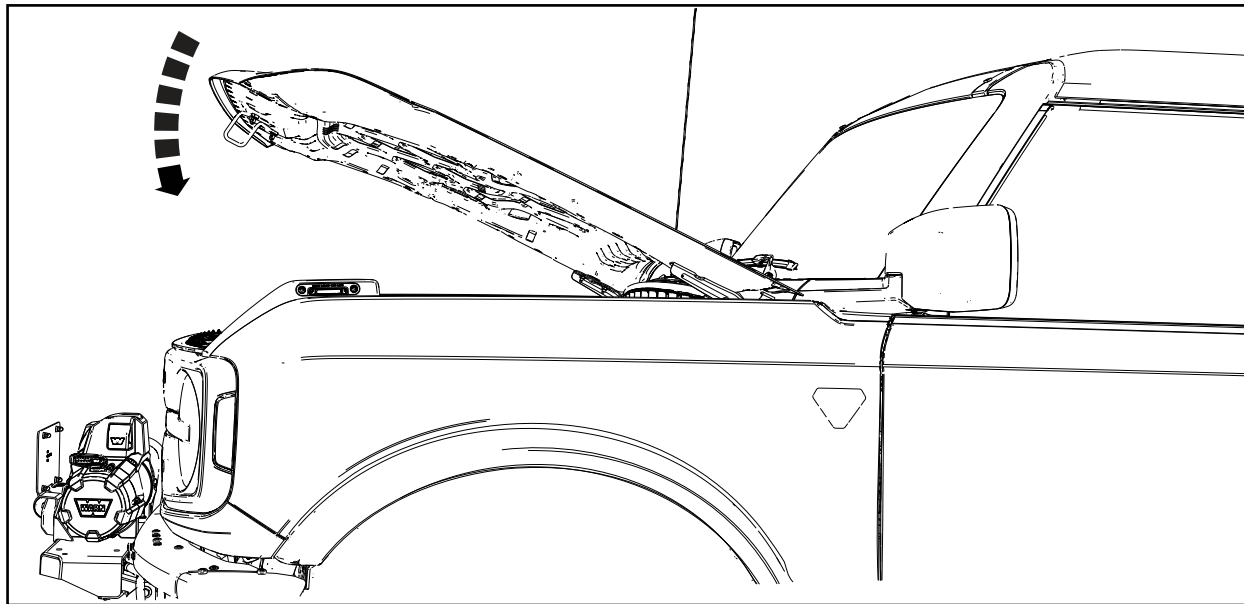

NO PART OF THIS DOCUMENT MAY BE REPRODUCED WITHOUT PRIOR AGREEMENT AND WRITTEN PERMISSION OF  
FORD PERFORMANCE PARTS

49. Install the left hand wheel well splash shield and retainers.

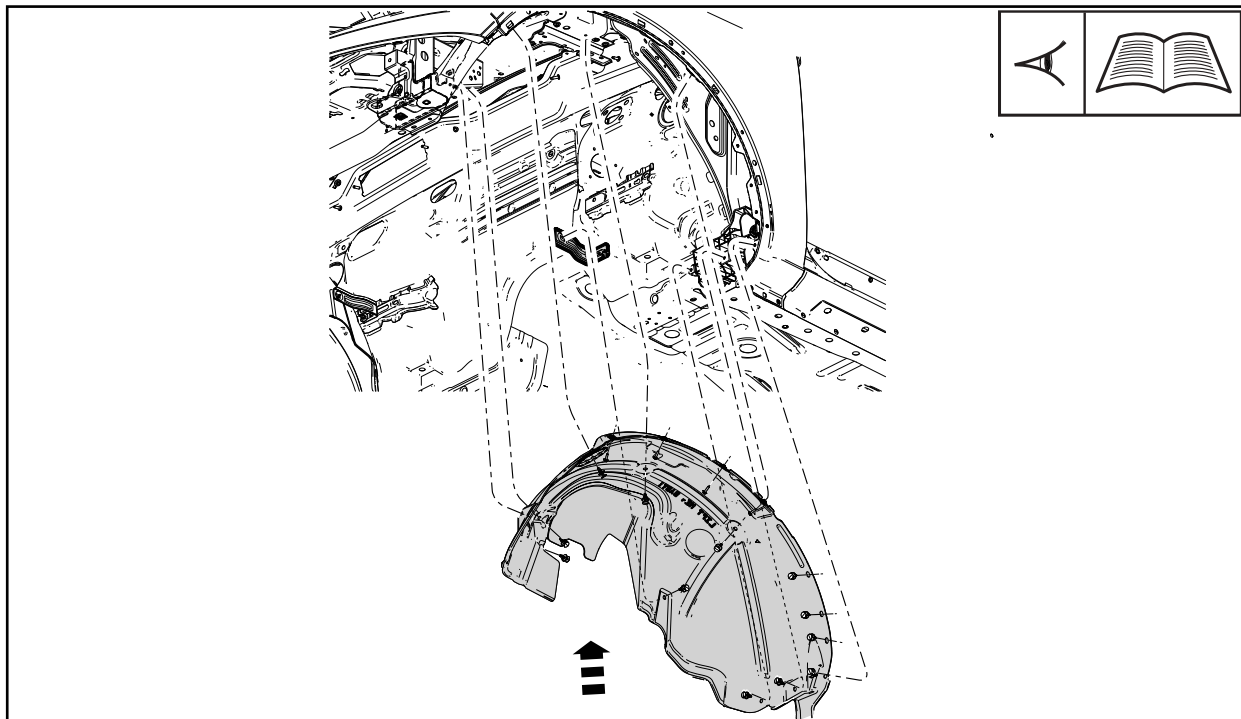

50. Install the left hand tire and lug nuts.

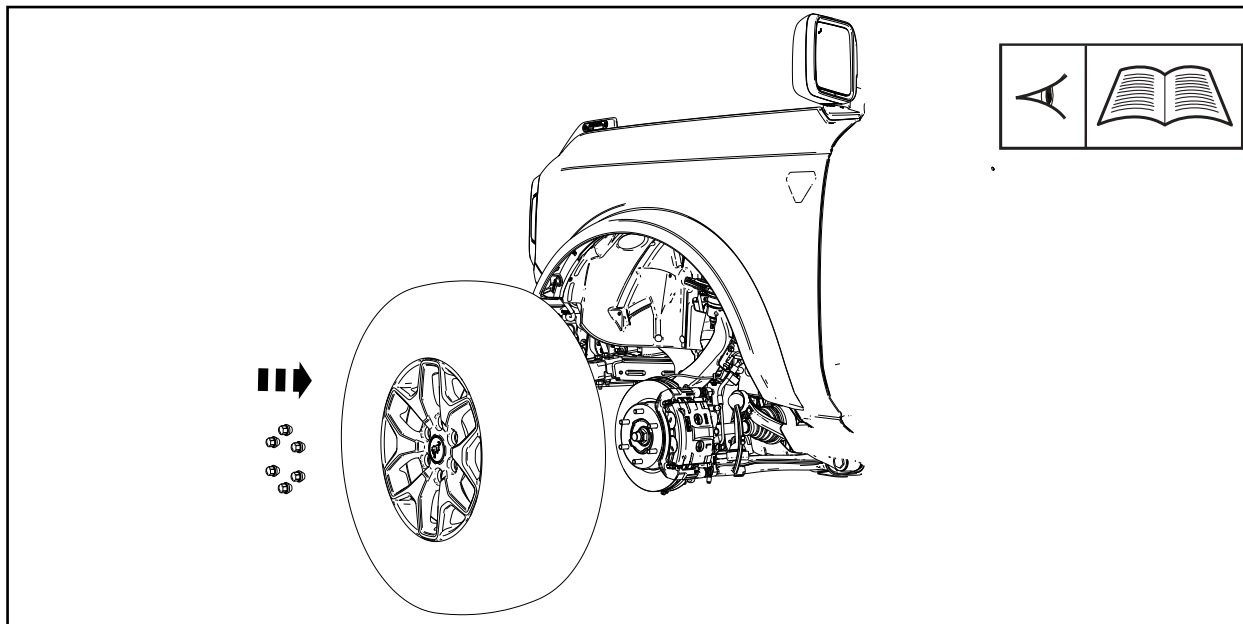

NO PART OF THIS DOCUMENT MAY BE REPRODUCED WITHOUT PRIOR AGREEMENT AND WRITTEN PERMISSION OF  
FORD PERFORMANCE PARTS

51. Install the left hand wheel well splash shield and retainers.

- Torque: 30 Nm (22 ft-lb)

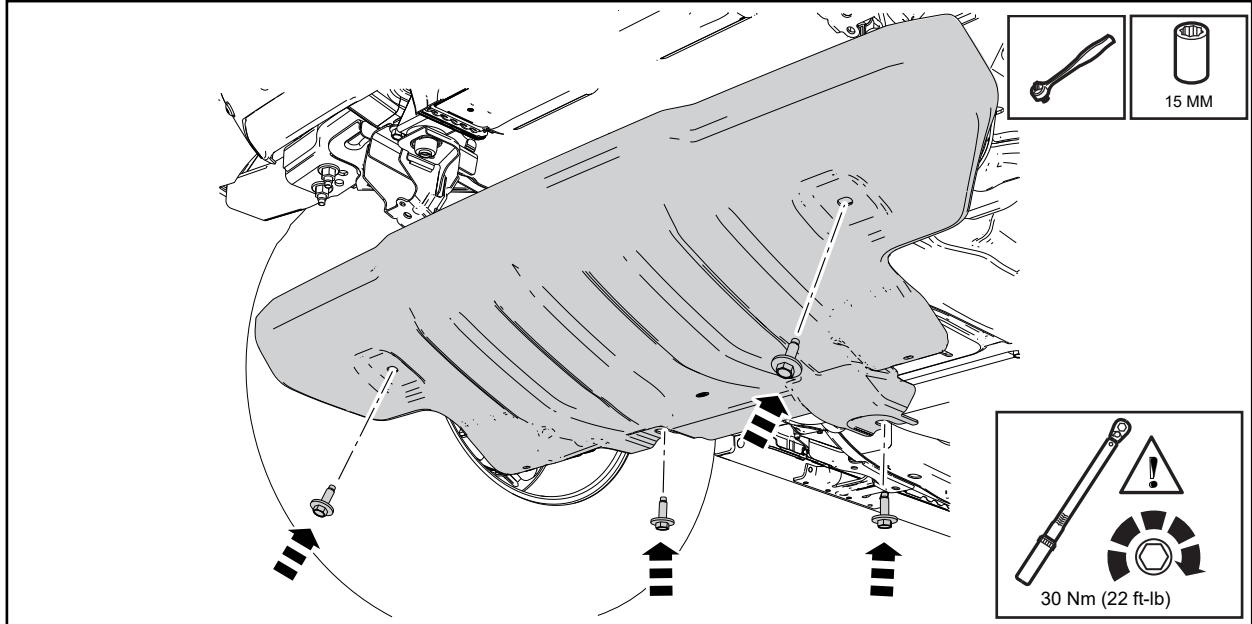

### Programming procedure:

52. Connect Ford Diagnostic & Repair System (FDRS) and start a new vehicle session.
53. Select "Toolbox", then scroll down to "RCM - Restraint Control Module". On the left hand side of the screen download the "RCM - Winch Configuration"
54. Select "Run" after the download has completed. Follow the on-screen instructions to complete the RCM - Winch Configuration.

**NOTE:** During the programming procedure you will be prompted to enter the Winch part number M-1821, M2DB-19E536, or M2DZ-19E536. The part numbers are case sensitive and do not require a suffix.

55. Vehicles equipped with front parking aid sensors - Check the alignment of the front parking aid sensors. Follow Workshop Manual - Azimuth System Check and Elevation System Check Section 413-13A.